

Dietrich School District #314
Work Session School Board Meeting
October 26, 2021
6 P.M. Conference Room

1. Call to Order
2. Pledge of Allegiance

3. Census Work
 - a. Calculating Zone Populations
4. Changing Zone Lines **Action**

5. Adjournment **Action**

Mission and Vision

MISSION STATEMENT:

WE EXIST TO EDUCATE,
EMPOWER, AND PREPARE
STUDENTS FOR A
PRODUCTIVE LIFE.

OUR VISION:

DIETRICH SCHOOL DISTRICTS
VISION IS TO MAINTAIN A
CULTURE WHERE RESPECT,
INTEGRITY, AND
PERSEVERANCE ARE
CULTIVATED. OPERATE A SAFE
AND WELCOMING SCHOOL
WHERE EACH STUDENT IS
CHALLENGED TO ACHIEVE
EXCELLENCE IN PREPARATION
FOR COLLEGE, CAREER, AND A
PRODUCTIVE LIFE.

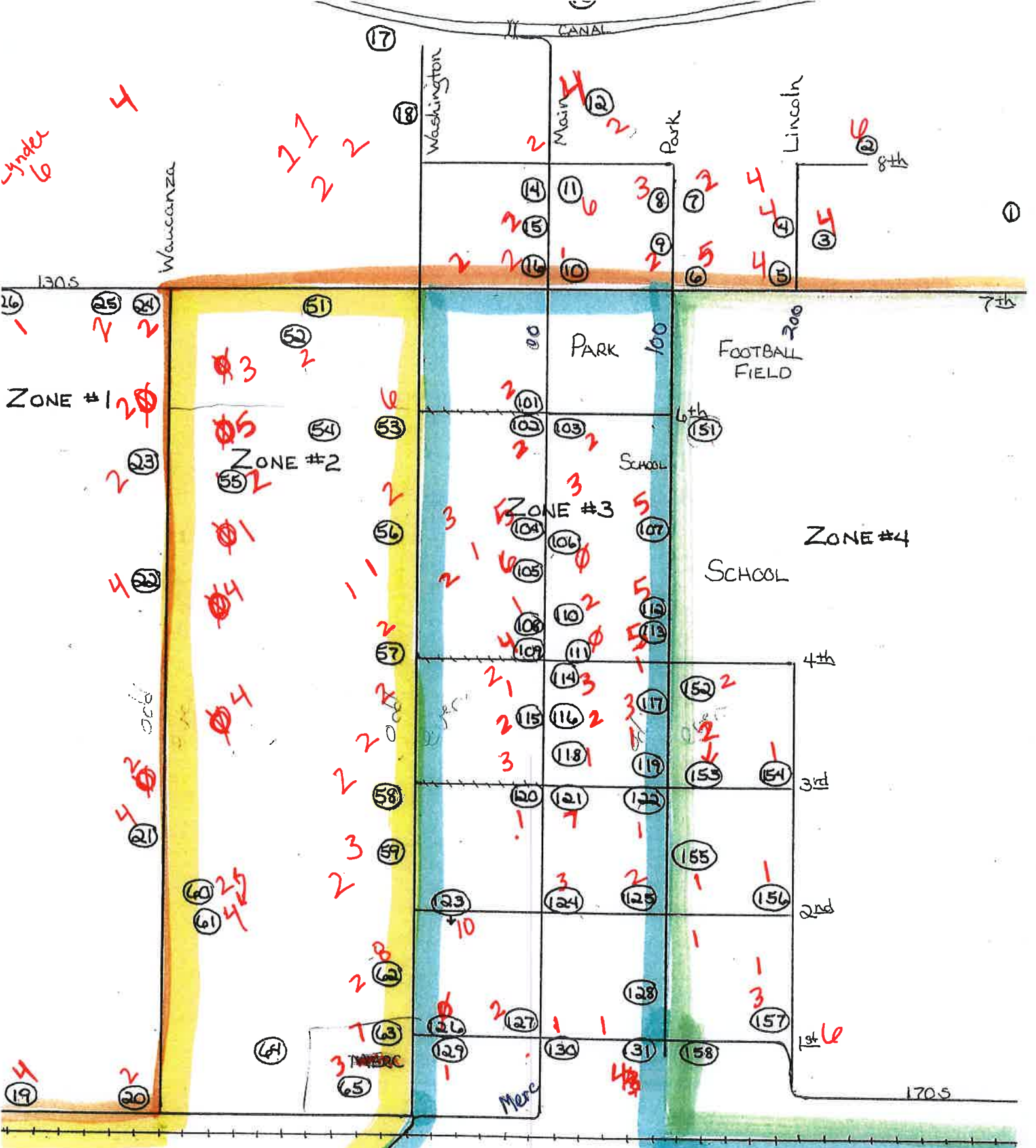

DIETRICH
TOWN DETAIL

Zone 2

~~3~~ 3 2
1 2
5 3
1
2
1
2
6
2
1
3
3
5
4
2
5
8
2
2
2
4

Zone 1

1
4
1
1
2
2
2
2
1
2
2
7
2

Zone 3

2
5
6
6
3
2
1

Zone 4

5
10
~~8~~ 7
2
5
11
3
2
2
6
2
7
6
3
2
2
6
2
2
7
2
1
6
2
2
2
4
5
3.

Zone 5

5
1
1
6
2.
1
2
1
0
8
5
2
2
3
2
3
3
3
1
2
2
5
2

Zone One:

96 in town - Rick
27 country
123 total

Zone Two:

70 in town Polly
71 country
141 total

Zone Three:

96 in town - Ben
25 country
121 total

Zone Four:

119 country star
18 in town
137 total - 8 to 5

Zone Five: - Perry - 116 seasonal

67 - Not including
Hidden Valley

Zone-1 - 123
 Zone 2 - 129
 Zone 3 - 132
 Zone 4 - 129
 Zone 5 - 124

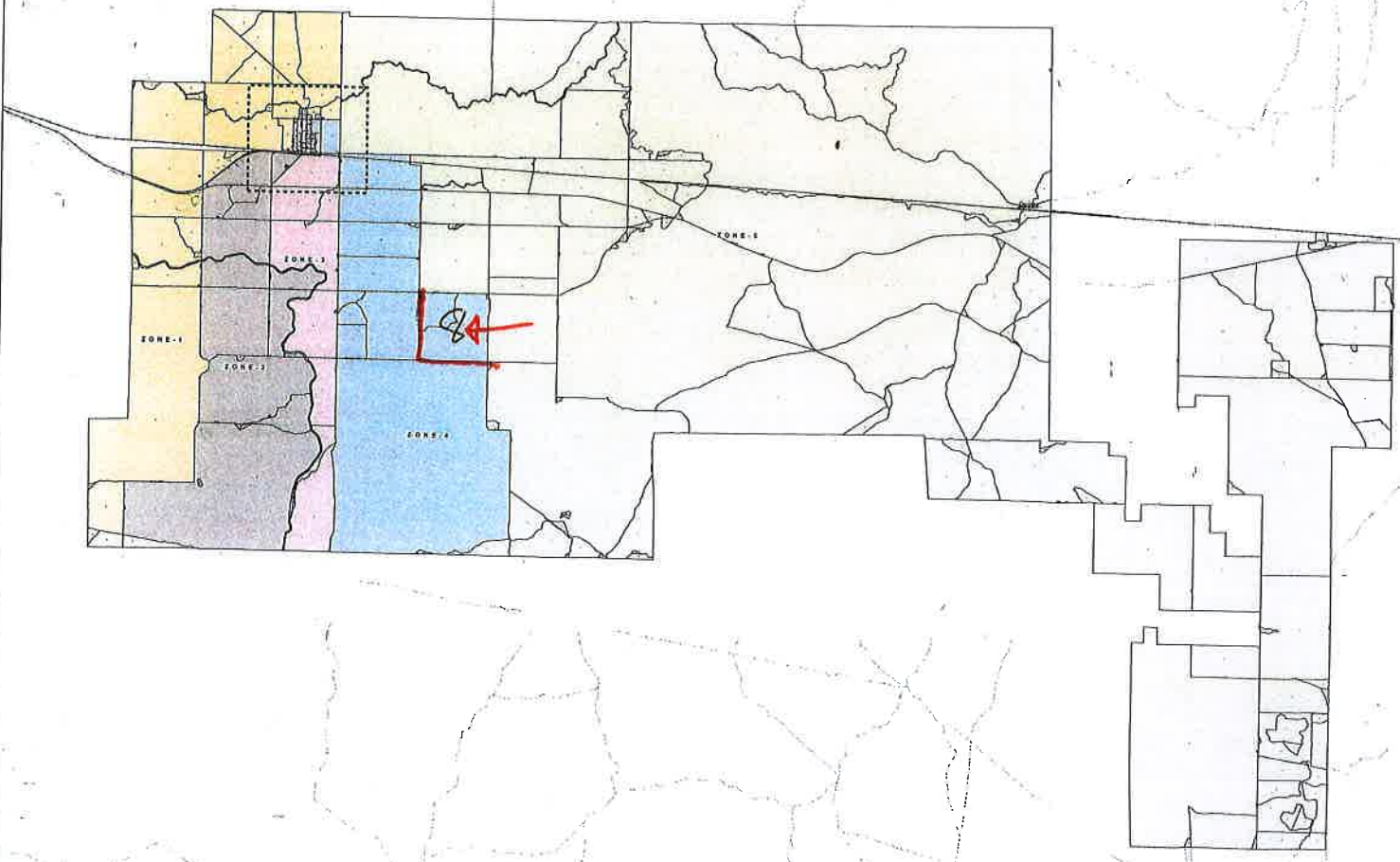
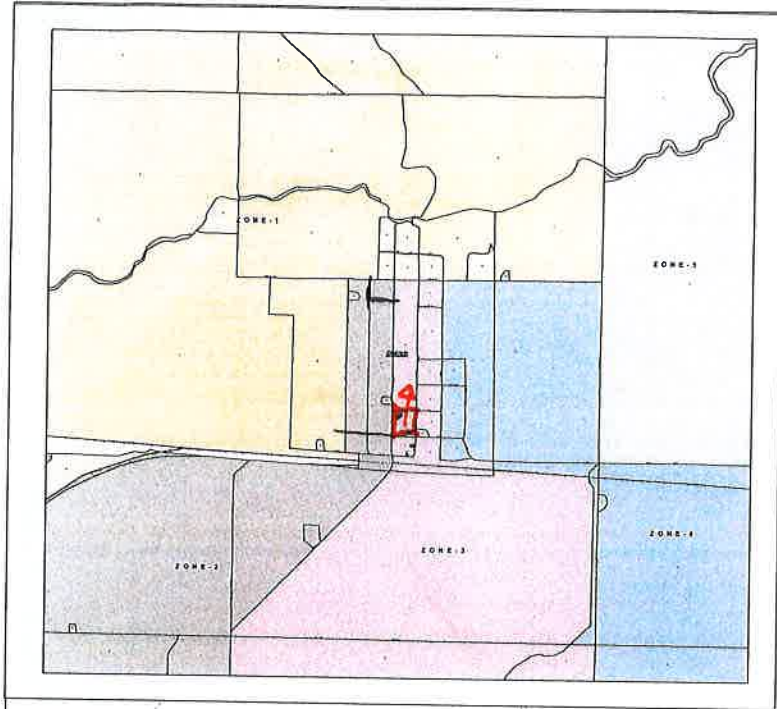

Dietrich School District #314
 2010 Trustee Zone Status Map



Legend

- City/Towns
 - Census Block/Population Count
 - Split Census Block
 - Primary Road
 - Secondary Road
 - Local Road
 - Jeep Trail
 - Other Roads
- Trustee Zones
 - ZONE-1
 - ZONE-2
 - ZONE-3
 - ZONE-4
 - ZONE-5
 - Inset Boundary

Highest Zone Population

Zone	Population	% Difference
1	154	4.1%
2	171	0.0%
3	165	3.5%
4	159	7.0%
5	157	8.2%
Total	816	
Target Zone Population	163	

Population Compliance
 The chart to the left depicts the 2010 Census populations of your existing Trustee Zones. If the % Difference* value is over 10%, then the Trustee Zones are out of compliance for "expected population".

Census Block Information
 If you see a bold outline around a census block, then that census block has population data which is being split by a current trustee zone boundary. The trustee zone boundaries should be modified to include ALL of the census block.

Questions/Contacts
 This map was prepared jointly by Quadrant Consulting Inc (QC) and Millennium Science & Engineering (MSE). If you have questions please contact:
 Quadrant Consulting
 Steve Street
 Steve@quadrant.co
 (202) 342-0091
 Millennium Science & Engineering
 Greg Carney
 gcarney@mse-nv.com
 (505) 445-4392

Data Sources
 Census 2010
 Census 2000
 Census 1990
 Census 1980
 Census 1970
 Census 1960
 Census 1950
 Census 1940
 Census 1930
 Census 1920
 Census 1910
 Census 1900
 Census 1890
 Census 1880
 Census 1870
 Census 1860
 Census 1850
 Census 1840
 Census 1830
 Census 1820
 Census 1810
 Census 1800
 Census 1790
 Census 1780
 Census 1770
 Census 1760
 Census 1750
 Census 1740
 Census 1730
 Census 1720
 Census 1710
 Census 1700
 Census 1690
 Census 1680
 Census 1670
 Census 1660
 Census 1650
 Census 1640
 Census 1630
 Census 1620
 Census 1610
 Census 1600
 Census 1590
 Census 1580
 Census 1570
 Census 1560
 Census 1550
 Census 1540
 Census 1530
 Census 1520
 Census 1510
 Census 1500
 Census 1490
 Census 1480
 Census 1470
 Census 1460
 Census 1450
 Census 1440
 Census 1430
 Census 1420
 Census 1410
 Census 1400
 Census 1390
 Census 1380
 Census 1370
 Census 1360
 Census 1350
 Census 1340
 Census 1330
 Census 1320
 Census 1310
 Census 1300
 Census 1290
 Census 1280
 Census 1270
 Census 1260
 Census 1250
 Census 1240
 Census 1230
 Census 1220
 Census 1210
 Census 1200
 Census 1190
 Census 1180
 Census 1170
 Census 1160
 Census 1150
 Census 1140
 Census 1130
 Census 1120
 Census 1110
 Census 1100
 Census 1090
 Census 1080
 Census 1070
 Census 1060
 Census 1050
 Census 1040
 Census 1030
 Census 1020
 Census 1010
 Census 1000
 Census 990
 Census 980
 Census 970
 Census 960
 Census 950
 Census 940
 Census 930
 Census 920
 Census 910
 Census 900
 Census 890
 Census 880
 Census 870
 Census 860
 Census 850
 Census 840
 Census 830
 Census 820
 Census 810
 Census 800
 Census 790
 Census 780
 Census 770
 Census 760
 Census 750
 Census 740
 Census 730
 Census 720
 Census 710
 Census 700
 Census 690
 Census 680
 Census 670
 Census 660
 Census 650
 Census 640
 Census 630
 Census 620
 Census 610
 Census 600
 Census 590
 Census 580
 Census 570
 Census 560
 Census 550
 Census 540
 Census 530
 Census 520
 Census 510
 Census 500
 Census 490
 Census 480
 Census 470
 Census 460
 Census 450
 Census 440
 Census 430
 Census 420
 Census 410
 Census 400
 Census 390
 Census 380
 Census 370
 Census 360
 Census 350
 Census 340
 Census 330
 Census 320
 Census 310
 Census 300
 Census 290
 Census 280
 Census 270
 Census 260
 Census 250
 Census 240
 Census 230
 Census 220
 Census 210
 Census 200
 Census 190
 Census 180
 Census 170
 Census 160
 Census 150
 Census 140
 Census 130
 Census 120
 Census 110
 Census 100
 Census 90
 Census 80
 Census 70
 Census 60
 Census 50
 Census 40
 Census 30
 Census 20
 Census 10
 Census 0

Zones Corrected for Compliance June 2011

Quadrant Consulting Inc
 1000 West 10th Street
 Reno, NV 89502
 Phone: (775) 785-1100
 Fax: (775) 785-1101
 Email: sales@quadrant.co

Millennium Science & Engineering
 1000 West 10th Street
 Reno, NV 89502
 Phone: (775) 785-1100
 Fax: (775) 785-1101
 Email: gcarney@mse-nv.com

Data Sources
 Census 2010
 Census 2000
 Census 1990
 Census 1980
 Census 1970
 Census 1960
 Census 1950
 Census 1940
 Census 1930
 Census 1920
 Census 1910
 Census 1900
 Census 1890
 Census 1880
 Census 1870
 Census 1860
 Census 1850
 Census 1840
 Census 1830
 Census 1820
 Census 1810
 Census 1800
 Census 1790
 Census 1780
 Census 1770
 Census 1760
 Census 1750
 Census 1740
 Census 1730
 Census 1720
 Census 1710
 Census 1700
 Census 1690
 Census 1680
 Census 1670
 Census 1660
 Census 1650
 Census 1640
 Census 1630
 Census 1620
 Census 1610
 Census 1600
 Census 1590
 Census 1580
 Census 1570
 Census 1560
 Census 1550
 Census 1540
 Census 1530
 Census 1520
 Census 1510
 Census 1500
 Census 1490
 Census 1480
 Census 1470
 Census 1460
 Census 1450
 Census 1440
 Census 1430
 Census 1420
 Census 1410
 Census 1400
 Census 1390
 Census 1380
 Census 1370
 Census 1360
 Census 1350
 Census 1340
 Census 1330
 Census 1320
 Census 1310
 Census 1300
 Census 1290
 Census 1280
 Census 1270
 Census 1260
 Census 1250
 Census 1240
 Census 1230
 Census 1220
 Census 1210
 Census 1200
 Census 1190
 Census 1180
 Census 1170
 Census 1160
 Census 1150
 Census 1140
 Census 1130
 Census 1120
 Census 1110
 Census 1100
 Census 1090
 Census 1080
 Census 1070
 Census 1060
 Census 1050
 Census 1040
 Census 1030
 Census 1020
 Census 1010
 Census 1000
 Census 990
 Census 980
 Census 970
 Census 960
 Census 950
 Census 940
 Census 930
 Census 920
 Census 910
 Census 900
 Census 890
 Census 880
 Census 870
 Census 860
 Census 850
 Census 840
 Census 830
 Census 820
 Census 810
 Census 800
 Census 790
 Census 780
 Census 770
 Census 760
 Census 750
 Census 740
 Census 730
 Census 720
 Census 710
 Census 700
 Census 690
 Census 680
 Census 670
 Census 660
 Census 650
 Census 640
 Census 630
 Census 620
 Census 610
 Census 600
 Census 590
 Census 580
 Census 570
 Census 560
 Census 550
 Census 540
 Census 530
 Census 520
 Census 510
 Census 500
 Census 490
 Census 480
 Census 470
 Census 460
 Census 450
 Census 440
 Census 430
 Census 420
 Census 410
 Census 400
 Census 390
 Census 380
 Census 370
 Census 360
 Census 350
 Census 340
 Census 330
 Census 320
 Census 310
 Census 300
 Census 290
 Census 280
 Census 270
 Census 260
 Census 250
 Census 240
 Census 230
 Census 220
 Census 210
 Census 200
 Census 190
 Census 180
 Census 170
 Census 160
 Census 150
 Census 140
 Census 130
 Census 120
 Census 110
 Census 100
 Census 90
 Census 80
 Census 70
 Census 60
 Census 50
 Census 40
 Census 30
 Census 20
 Census 10
 Census 0