

TOPOGRAPHIC SURVEY
LOCATED IN THE NORTHWEST ONE-QUARTER OF SECTION 34,
TOWNSHIP 13 NORTH, RANGE 5 WEST, WILLAMETTE MERIDIAN,
LEWIS COUNTY, WASHINGTON

FIELD SURVEYED: AUGUST 2024

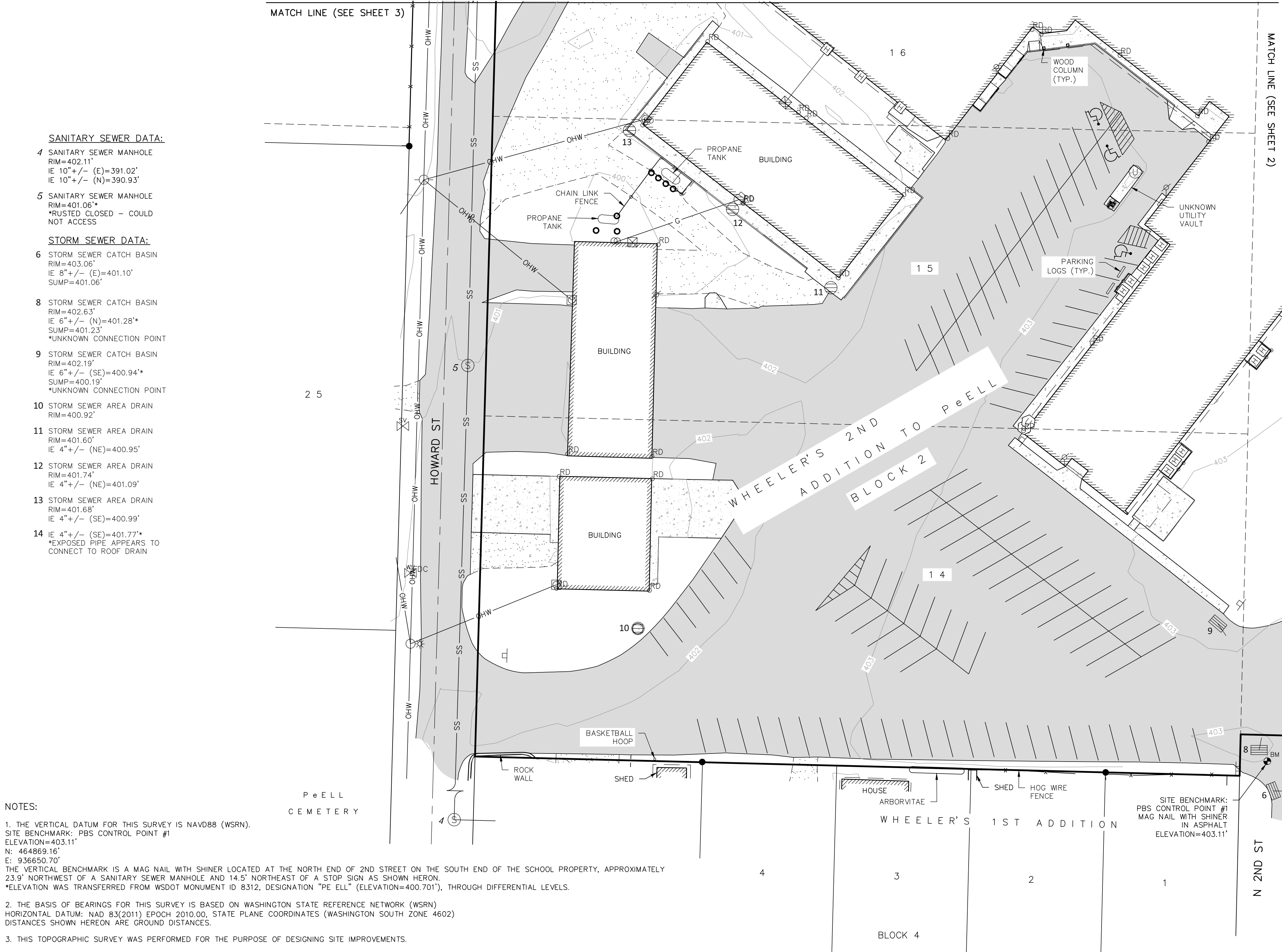

NOTES:

1. THE VERTICAL DATUM FOR THIS SURVEY IS NAVD88 (WSRN).
SITE BENCHMARK: PBS CONTROL POINT #1
ELEVATION=403.11'
N: 464869.16'
E: 936650.70'
THE VERTICAL BENCHMARK IS A MAG NAIL WITH SHINER LOCATED AT THE NORTH END OF 2ND STREET ON THE SOUTH END OF THE SCHOOL PROPERTY, APPROXIMATELY 23.9' NORTHWEST OF A SANITARY SEWER MANHOLE AND 14.5' NORTHEAST OF A STOP SIGN AS SHOWN HEREON.
*ELEVATION WAS TRANSFERRED FROM WSDOT MONUMENT ID 8312, DESIGNATION "PE ELL" (ELEVATION=400.701'), THROUGH DIFFERENTIAL LEVELS.
2. THE BASIS OF BEARINGS FOR THIS SURVEY IS BASED ON WASHINGTON STATE REFERENCE NETWORK (WSRN)
HORIZONTAL DATUM: NAD 83(2011) EPOCH 2010.00, STATE PLANE COORDINATES (WASHINGTON SOUTH ZONE 4602)
DISTANCES SHOWN HEREON ARE GROUND DISTANCES.
3. THIS TOPOGRAPHIC SURVEY WAS PERFORMED FOR THE PURPOSE OF DESIGNING SITE IMPROVEMENTS.
4. CONTOURS DERIVED BY DIRECT FIELD OBSERVATIONS. ELEVATION AND CONTOUR ACCURACY IS ONE-HALF THE CONTOUR INTERVAL.
5. THIS MAP HAS BEEN PRODUCED FOR DESIGN PURPOSES AND SHOWS AN ACCURATE BOUNDARY DEPICTION.
6. BOUNDARIES SHOWN HAVE BEEN DETERMINED.
7. THE UNDERGROUND UTILITIES SHOWN HEREON WERE BASED ON FIELD MEASUREMENT OF UTILITY LOCATE PAINT MARKS SUPPLIED BY THE WASHINGTON UTILITY NOTIFICATION CENTER (PRE-SURVEY TICKET REQUESTS SUBMITTED ON 8/6/2024 AND PROCESSED AS TICKET NUMBERS 24329392, 24329393, AND 24329394) AS WELL AS SURFACE EVIDENCE AND PRIVATE ASBUILT RECORDS. HOWEVER, LACKING EXCAVATION, THE EXACT LOCATION OF UNDERGROUND FEATURES CANNOT BE ACCURATELY, COMPLETELY AND RELIABLY DEPICTED. WHERE ADDITIONAL OR MORE DETAILED INFORMATION IS REQUIRED, THE CLIENT IS ADVISED THAT EXCAVATION MAY BE NECESSARY. ADDITIONALLY, CERTAIN UTILITIES ONSITE (WATER, SANITARY, STORM, GAS, ETC.) MAY NOT HAVE CONDUCTIBLE OR TRACEABLE LINES AND MAY BE PRESENT.
*PRIVATE ON-SITE CONDUCTIBLE UTILITY LOCATES WERE PERFORMED BY ALPHA LOCATES, LLC ON 8/7/2024.
8. MANHOLE PIPE SIZES AND PIPE ELEVATION DATA ARE MEASURED WITHOUT PERSONNEL ENTERING INTO THE MANHOLE STRUCTURES DUE TO POTENTIAL HAZARDS. THEREFORE, SUCH DATA MAY BE APPROXIMATE DEPENDING ON THE DEPTH AND SIZE, A REASONABLE MARGIN OF ERROR ON PIPE SIZE IS +/-2", AND PIPE ELEVATIONS MAY HAVE A MARGIN OF ERROR OF +/-0.1' UNLESS NOTED OTHERWISE.
9. FINISH FLOOR ELEVATIONS WERE OBTAINED AT THE EXTERIOR DOOR OPENING OF EACH BUILDING. NOT ALL TENANTS WERE PRESENT TO ALLOW ACCESS FOR TRUE FINISH FLOOR ELEVATIONS ON THE INTERIOR OF THE BUILDING. FINISH FLOOR ELEVATIONS ARE APPROXIMATE ONLY.
10. ANY MONUMENT DISTURBED WILL BE REPLACED AT THE CONTRACTOR'S EXPENSE PER CONTRACT SPECIFICATIONS. (SEE WAC 332-120-030) (SEE ORS 209.150)

LEGEND:

- BM - DENOTES SITE BENCHMARK
- - DENOTES FOUND SURVEY MONUMENT
- ASPHALT - DENOTES ASPHALT SURFACE
- CONCRETE - DENOTES CONCRETE SURFACE
- GRAVEL - DENOTES GRAVEL SURFACE
- EXISTING BUILDING - DENOTES EXISTING BUILDING AS NOTED
- 5' CONTOUR - DENOTES 5' CONTOUR INTERVAL
- 1' CONTOUR - DENOTES 1' CONTOUR INTERVAL
- ROAD CENTERLINE - DENOTES ROAD CENTERLINE
- RIGHT OF WAY - DENOTES RIGHT OF WAY LINE
- PROPERTY LOT - DENOTES PROPERTY LOT LINE
- FENCE - DENOTES FENCE LINE AS NOTED
- HANDRAIL - DENOTES HANDRAIL
- OVERHEAD WIRE - DENOTES OVERHEAD WIRE
- GAS LINE - DENOTES GAS LINE PER UTILITY LOCATE PAINT/VISUAL FIELD OBSERVATION
- POWER/SIGNAL LINE - DENOTES POWER/SIGNAL LINE PER UTILITY LOCATE PAINT/VISUAL FIELD OBSERVATION
- STORM DRAINAGE LINE - DENOTES STORM DRAINAGE LINE PER UTILITY LOCATE PAINT/VISUAL FIELD OBSERVATION
- SANITARY SEWER LINE - DENOTES SANITARY SEWER LINE PER UTILITY LOCATE PAINT/VISUAL FIELD OBSERVATION
- STORM DRAINAGE AREA DRAIN - DENOTES STORM DRAINAGE AREA DRAIN
- STORM DRAINAGE CATCH BASIN - DENOTES STORM DRAINAGE CATCH BASIN
- ROOF DRAIN - DENOTES ROOF DRAIN
- SANITARY SEWER MANHOLE - DENOTES SANITARY SEWER MANHOLE
- WATER METER - DENOTES WATER METER
- WATER VALVE - DENOTES WATER VALVE
- WATER SPIGOT - DENOTES WATER SPIGOT
- FIRE DEPT CONNECTION - DENOTES FIRE DEPT CONNECTION
- SPRINKLER VALVE - DENOTES SPRINKLER VALVE
- GAS METER - DENOTES GAS METER
- POWER METER - DENOTES POWER METER
- POWER RISER - DENOTES POWER RISER
- POWER POLE - DENOTES POWER POLE
- POWER POLE W/ LIGHT - DENOTES POWER POLE W/ LIGHT
- TRAFFIC/SIGNAL JUNCTION BOX - DENOTES TRAFFIC/SIGNAL JUNCTION BOX
- TRAFFIC SIGNAL POLE - DENOTES TRAFFIC SIGNAL POLE
- TRAFFIC SIGNAL CROSSING POLE - DENOTES TRAFFIC SIGNAL CROSSING POLE
- COMMUNICATIONS RISER - DENOTES COMMUNICATIONS RISER
- COMMUNICATIONS MANHOLE - DENOTES COMMUNICATIONS MANHOLE
- COMMUNICATIONS VAULT - DENOTES COMMUNICATIONS VAULT
- UTILITY CABINET - DENOTES UTILITY CABINET
- UNKNOWN UTILITY MANHOLE - DENOTES UNKNOWN UTILITY MANHOLE
- UNKNOWN UTILITY STANDPIPE - DENOTES UNKNOWN UTILITY STANDPIPE
- HVAC UNIT - DENOTES HVAC UNIT
- MONITOR WELL - DENOTES MONITOR WELL
- BOLLARD - DENOTES BOLLARD
- SIGN - DENOTES SIGN
- GATE POST - DENOTES GATE POST



Scale 1" = 30'



PBS Engineering and
Environmental LLC
1325 SE Tech Center Dr., Ste. 140
Vancouver, WA 98683
360.695.3488
pbsuaa.com

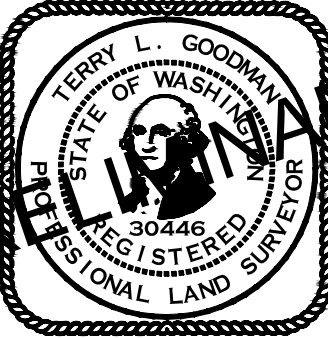
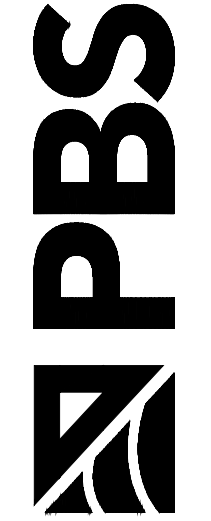

TOPOGRAPHIC SURVEY

PE ELL K-12 SCHOOL

519 N 2ND ST

PE ELL, WA 98572

REVISIONS

REV.	DESCRIPTION:

DATE 9/4/2024

DRAWN MDL/TLG

SURVEYED TRG/JSF/JCB

CHECKED TLG

JOB NO.:

78253-00

DRAWING NAME:

78253-000-TOPO

SHEET NO.

1/6

TOPOGRAPHIC SURVEY
LOCATED IN THE NORTHWEST ONE-QUARTER OF SECTION 34,
TOWNSHIP 13 NORTH, RANGE 5 WEST, WILLAMETTE MERIDIAN,
LEWIS COUNTY, WASHINGTON

FIELD SURVEYED: AUGUST 2024

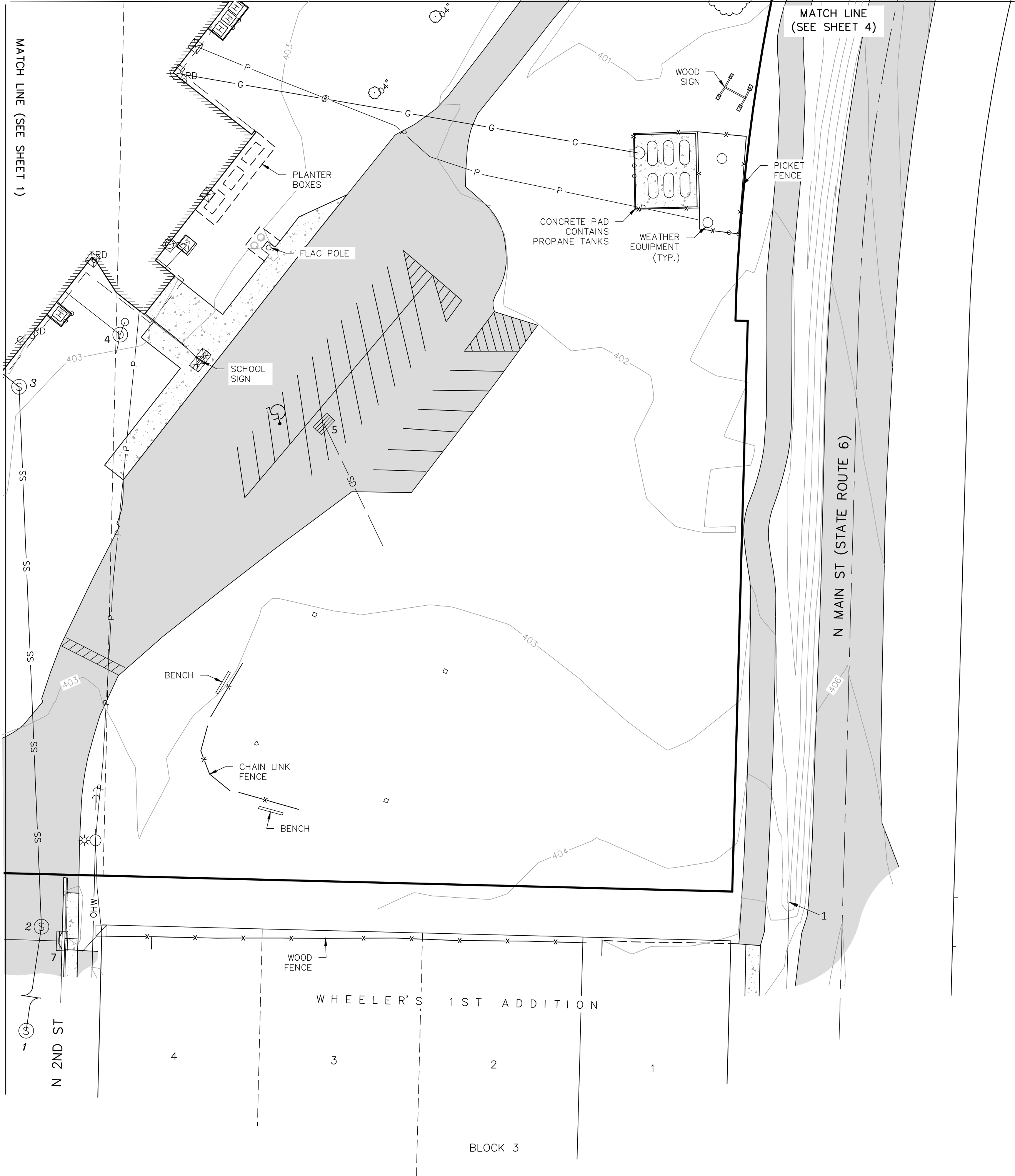

STORM SEWER DATA:

- 1 IE 12"+/- CPP (S)=402.52'
4 STORM SEWER MANHOLE
RIM=402.83'
IE 8"+/- (N)=398.85'
IE 8"+/- (W)=398.83'*
IE 8"+/- (S)=398.75'*
*UNKNOWN CONNECTION POINT
- COULD NOT FIELD VERIFY
5 STORM SEWER CATCH BASIN
RIM=402.17'
IE 6"+/- (SE)=400.71'*
SUMP=399.81'
*PIPE APPEARS TO DAYLIGHT
INTO GRASS - UNKNOWN
CONNECTION POINT
7 STORM SEWER CATCH BASIN
RIM=403.58'
IE 8"+/- (W)=400.90'
IE 8"+/- (S)=400.93'
SUMP=400.28'

SANITARY SEWER DATA:

- 1 SANITARY SEWER MANHOLE
RIM=404.13'
IE 8"+/- (N)=396.63'
2 SANITARY SEWER MANHOLE
RIM=403.61'
IE 8"+/- (N)=397.12'
IE 8"+/- (S)=396.91'
3 SANITARY SEWER MANHOLE
RIM=403.22'
IE 6"+/- (W)=398.43'*
IE 8"+/- (S)=398.34'*
*APPEARS TO CONNECT TO
BUILDING - COULD NOT FIELD
VERIFY

LEGEND:

- BM - DENOTES SITE BENCHMARK (SEE SHEET 2)
• - DENOTES FOUND SURVEY MONUMENT
- DENOTES ASPHALT SURFACE
- DENOTES CONCRETE SURFACE
- DENOTES EXISTING BUILDING AS NOTED
- DENOTES 5' CONTOUR INTERVAL
- DENOTES 1' CONTOUR INTERVAL
- DENOTES ROAD CENTERLINE
- DENOTES RIGHT OF WAY LINE
- DENOTES PROPERTY/LOT LINE
- DENOTES FENCE LINE AS NOTED
- DENOTES HANDRAIL
- DENOTES OVERHEAD WIRE
- DENOTES COMMUNICATIONS LINE PER UTILITY LOCATE PAINT/VISUAL FIELD OBSERVATION
- DENOTES GAS LINE PER UTILITY LOCATE PAINT/VISUAL FIELD OBSERVATION
- DENOTES POWER/SIGNAL LINE PER UTILITY LOCATE PAINT/VISUAL FIELD OBSERVATION
- DENOTES STORM DRAINAGE LINE PER UTILITY LOCATE PAINT/VISUAL FIELD OBSERVATION
- DENOTES SANITARY SEWER LINE PER UTILITY LOCATE PAINT/VISUAL FIELD OBSERVATION
- DENOTES STORM DRAINAGE CATCH BASIN
- DENOTES STORM DRAINAGE MANHOLE
RD - DENOTES ROOF DRAIN
S - DENOTES SANITARY SEWER MANHOLE
- DENOTES WATER SPIGOT
- DENOTES GAS METER
- DENOTES POWER/ELECTRICAL TRANSFORMER
- DENOTES POWER METER
- DENOTES POWER RISER
- DENOTES POWER POLE W/ LIGHT
- DENOTES GUY WIRE/ANCHOR
- DENOTES COMMUNICATIONS RISER
- DENOTES UNKNOWN UTILITY STANDPIPE
- DENOTES HVAC UNIT
- DENOTES SIGN
- DENOTES GATE POST
- DENOTES BUSH/SHRUB
- DENOTES DECIDUOUS TREE

Scale 1" = 30'

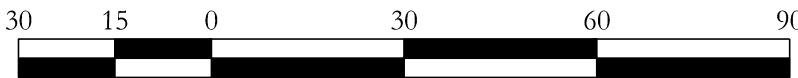

PBS Engineering and
Environmental LLC
1325 SE Tech Center Dr., Ste. 140
Vancouver, WA 98683
360.695.3488
pbsua.com

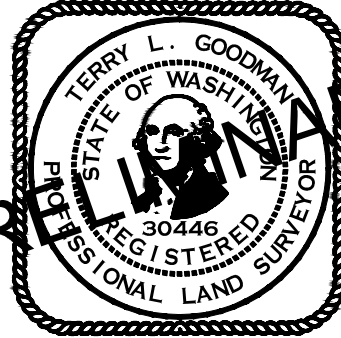
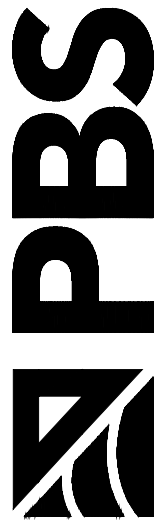

TOPOGRAPHIC SURVEY

PE ELL K-12 SCHOOL

519 N 2ND ST

PE ELL, WA 98572

REVISIONS

DESCRIPTION:

REV.:

DATE	9/4/2024
DRAWN	MDL/TLG
SURVEYED	TRG/JSF/JCB
CHECKED	TLG

JOB NO.:

78253-00

DRAWING NAME:

78253-000-TOPO

SHEET NO.

2/6

TOPOGRAPHIC SURVEY
LOCATED IN THE NORTHWEST ONE-QUARTER OF SECTION 34,
TOWNSHIP 13 NORTH, RANGE 5 WEST, WILLAMETTE MERIDIAN,
LEWIS COUNTY, WASHINGTON
FIELD SURVEYED: AUGUST 2024

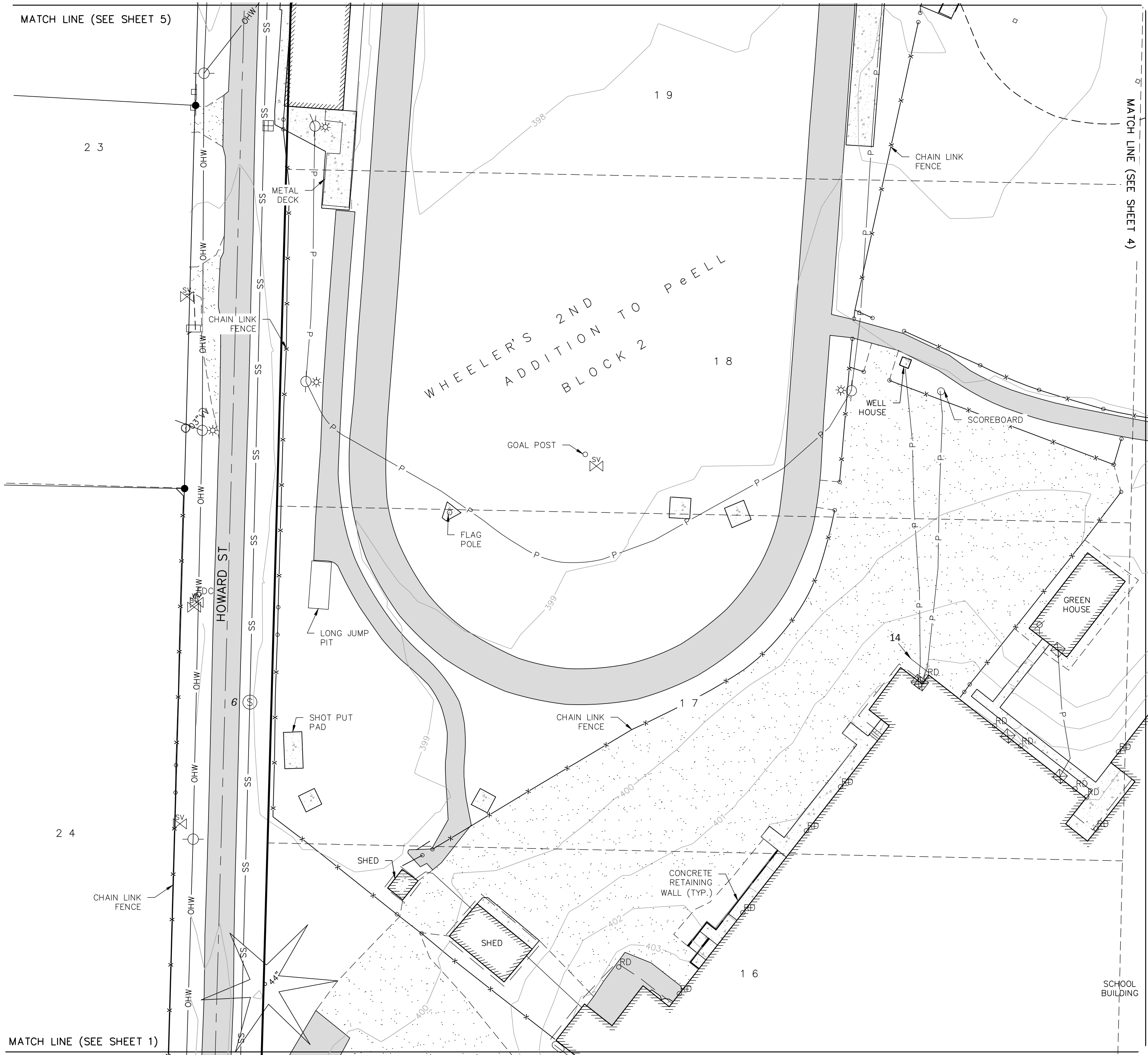

SANITARY SEWER DATA:

6 SANITARY SEWER MANHOLE
RIM=399.31'
IE 10'+/- (S)=388.22'
IE 10'+/- (N)=388.17'

STORM SEWER DATA:

14 IE 4'+/- (SE)=401.77'*
*EXPOSED PIPE APPEARS TO
CONNECT TO ROOF DRAIN

- LEGEND:
- BM - DENOTES SITE BENCHMARK (SEE SHEET 2)
 - - DENOTES FOUND SURVEY MONUMENT
 - - - - - DENOTES ASPHALT SURFACE
 - - - - - DENOTES CONCRETE SURFACE
 - - - - - DENOTES GRAVEL SURFACE
 - - - - - DENOTES EXISTING BUILDING AS NOTED
 - - - - - DENOTES 5' CONTOUR INTERVAL
 - - - - - DENOTES 1' CONTOUR INTERVAL
 - - - - - DENOTES ROAD CENTERLINE
 - - - - - DENOTES RIGHT OF WAY LINE
 - - - - - DENOTES PROPERTY/LOT LINE
 - - - - - DENOTES FENCE LINE AS NOTED
 - - - - - DENOTES HANDRAIL
 - - - - - DENOTES OVERHEAD WIRE
 - - - - - DENOTES POWER/SIGNAL LINE PER UTILITY LOCATE PAINT/VISUAL FIELD OBSERVATION
 - - - - - DENOTES STORM DRAINAGE LINE PER UTILITY LOCATE PAINT/VISUAL FIELD OBSERVATION
 - - - - - DENOTES SANITARY SEWER LINE PER UTILITY LOCATE PAINT/VISUAL FIELD OBSERVATION
 - RD - DENOTES ROOF DRAIN
 - ⊙ - DENOTES SANITARY SEWER MANHOLE
 - ⊕ - DENOTES WATER METER
 - ⊗ - DENOTES WATER VALVE
 - ⊗ - DENOTES WATER SPIGOT
 - ⊕ - DENOTES FIRE DEPT CONNECTION
 - ⊗ - DENOTES SPRINKLER VALVE
 - ⊗ - DENOTES POWER RISER
 - ⊗ - DENOTES POWER POLE
 - ⊗ - DENOTES POWER POLE W/ LIGHT
 - ⊗ - DENOTES GUY WIRE/ANCHOR
 - ⊗ - DENOTES UNKNOWN UTILITY STANDPIPE
 - ⊗ - DENOTES MAIL BOX
 - ⊗ - DENOTES SIGN
 - ⊗ - DENOTES GATE POST
 - ⊗ - DENOTES CONIFEROUS TREE
 - ⊗ - DENOTES DECIDUOUS TREE

PBS Engineering and Environmental LLC
1325 SE Tech Center Dr., Ste. 140
Vancouver, WA 98683
360.695.3488
pbsuaa.com

TOPOGRAPHIC SURVEY
PE ELL K-12 SCHOOL
519 N 2ND ST
PE ELL, WA 98572

REVISIONS	
REV.	DESCRIPTION:

DATE	9/4/2024
DRAWN	MDL/TLG
SURVEYED	TRG/JSF/JCB
CHECKED	TLG

JOB NO.:
78253-00

DRAWING NAME:
78253-000-TOP0

SHEET NO.:
3/6

LOCATED IN THE NORTHWEST ONE-QUARTER OF SECTION 34,
TOWNSHIP 13 NORTH, RANGE 5 WEST, WILLAMETTE MERIDIAN,
LEWIS COUNTY, WASHINGTON

FIELD SURVEYED: AUGUST 2024

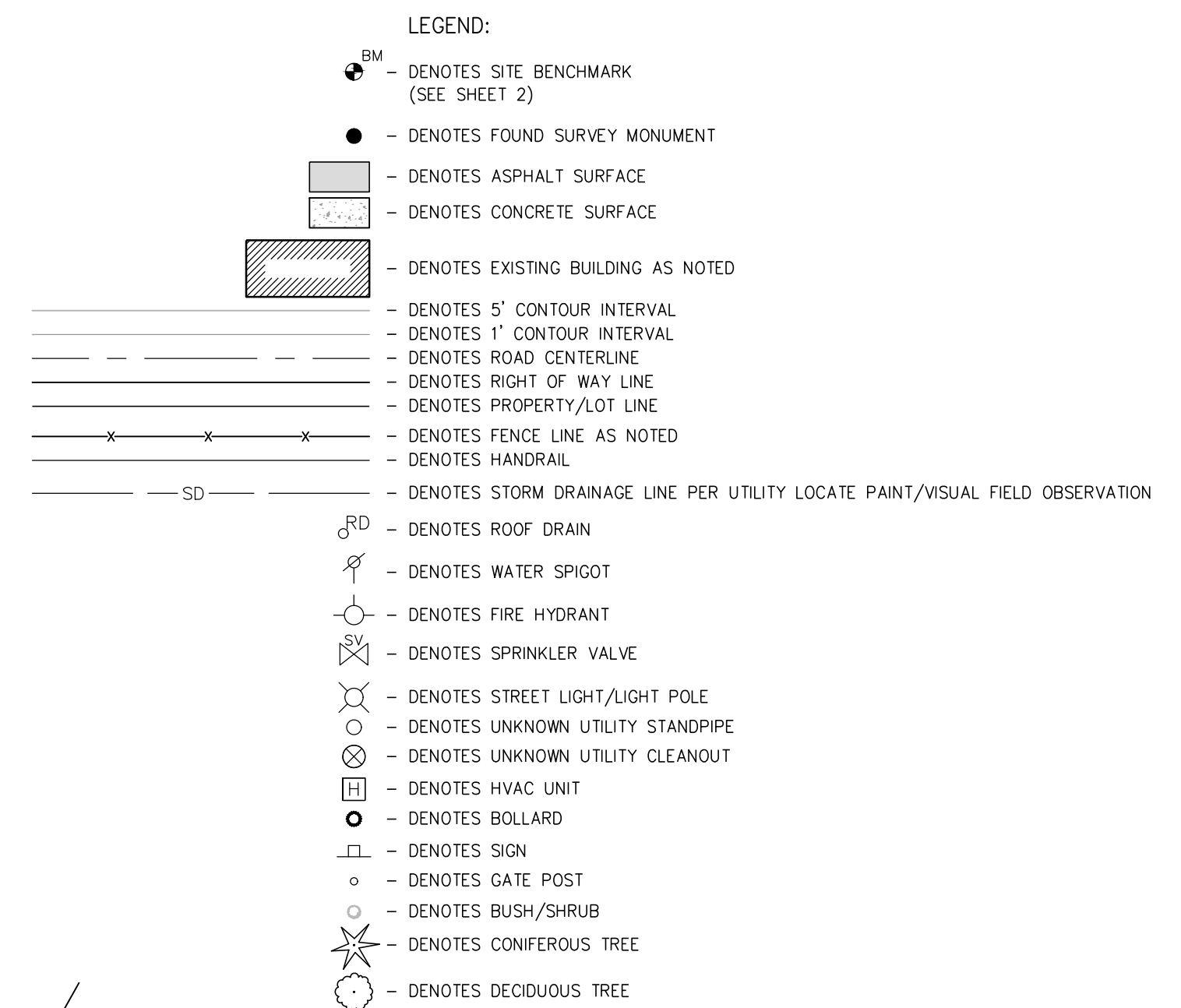

STORM SEWER DATA:

2 IE 8" + / - PVC (W) = 399.34'

3 IE 8" + / - PVC (E) = 399.39'

Scale 1" = 30'

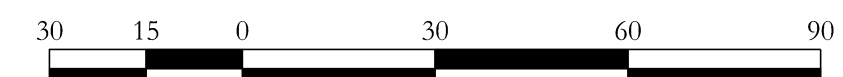

**PBS Engineering and
Environmental LLC**
1325 SE Tech Center Dr., Ste. 140
Vancouver, WA 98683
360.695.3488
pbsusa.com

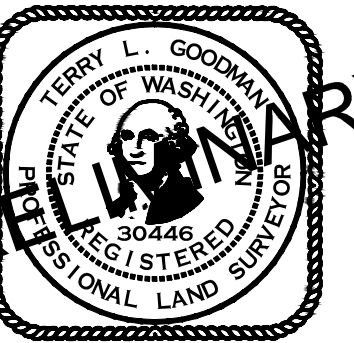

TOPOGRAPHIC SURVEY
PE ELL K-12 SCHOOL

519 N 2ND ST
PE ELL, WA 98572

[illegible]

DATE	9/4/2024
DRAWN	MDL/TLG
SURVEYED	TRG/JSF/JCB
CHECKED	TLG

JOB NO.:
78253-00

DRAWING NAME:
78253-000-TOPO

SHEET NO.

4/6

TOPOGRAPHIC SURVEY
LOCATED IN THE NORTHWEST ONE-QUARTER OF SECTION 34,
TOWNSHIP 13 NORTH, RANGE 5 WEST, WILLAMETTE MERIDIAN,
LEWIS COUNTY, WASHINGTON

FIELD SURVEYED: AUGUST 2024



SANITARY SEWER DATA:

- 7 SANITARY SEWER MANHOLE
RIM=395.08'
IE 10'+/- (S)=385.91'
IE 10'+/- (E)=385.68'
- 10 SANITARY SEWER MANHOLE
(POSSIBLE SEPTIC TANK)
RIM=398.24*
*BOLTED SHUT - COULD NOT ACCESS
- 11 SANITARY SEWER MANHOLE
RIM=398.07'
IE 10'+/- (S)=387.09'
IE 10'+/- (N)=386.93'

- LEGEND:
- BM - DENOTES SITE BENCHMARK (SEE SHEET 2)
 - - DENOTES FOUND SURVEY MONUMENT
 - ASPHALT - DENOTES ASPHALT SURFACE
 - CONCRETE - DENOTES CONCRETE SURFACE
 - GRAVEL - DENOTES GRAVEL SURFACE
 - BUILDING - DENOTES EXISTING BUILDING AS NOTED
 - 5' - DENOTES 5' CONTOUR INTERVAL
 - 1' - DENOTES 1' CONTOUR INTERVAL
 - ROAD - DENOTES ROAD CENTERLINE
 - WAY - DENOTES RIGHT OF WAY LINE
 - PROPERTY - DENOTES PROPERTY/LOT LINE
 - FENCE - DENOTES FENCE LINE AS NOTED
 - OHW - DENOTES OVERHEAD WIRE
 - P - DENOTES POWER/SIGNAL LINE PER UTILITY LOCATE PAINT/VISUAL FIELD OBSERVATION
 - SS - DENOTES SANITARY SEWER LINE PER UTILITY LOCATE PAINT/VISUAL FIELD OBSERVATION
 - W - DENOTES WATER LINE PER UTILITY LOCATE PAINT/VISUAL FIELD OBSERVATION
 - RD - DENOTES ROOF DRAIN
 - S - DENOTES SANITARY SEWER MANHOLE
 - WATER METER - DENOTES WATER METER
 - WATER SPIGOT - DENOTES WATER SPIGOT
 - FDC - DENOTES FIRE DEPT CONNECTION
 - SV - DENOTES SPRINKLER VALVE
 - TRANSFORMER - DENOTES POWER/ELECTRICAL TRANSFORMER
 - POWER JUNCTION BOX - DENOTES POWER JUNCTION BOX
 - POWER METER - DENOTES POWER METER
 - POWER POLE - DENOTES POWER POLE
 - POWER POLE W/ LIGHT - DENOTES POWER POLE W/ LIGHT
 - GUY WIRE/ANCHOR - DENOTES GUY WIRE/ANCHOR
 - STREET LIGHT/LIGHT POLE - DENOTES STREET LIGHT/LIGHT POLE
 - UNKNOWN UTILITY STANDPIPE - DENOTES UNKNOWN UTILITY STANDPIPE
 - UNKNOWN UTILITY CLEANOUT - DENOTES UNKNOWN UTILITY CLEANOUT
 - SIGN - DENOTES SIGN
 - GATE POST - DENOTES GATE POST

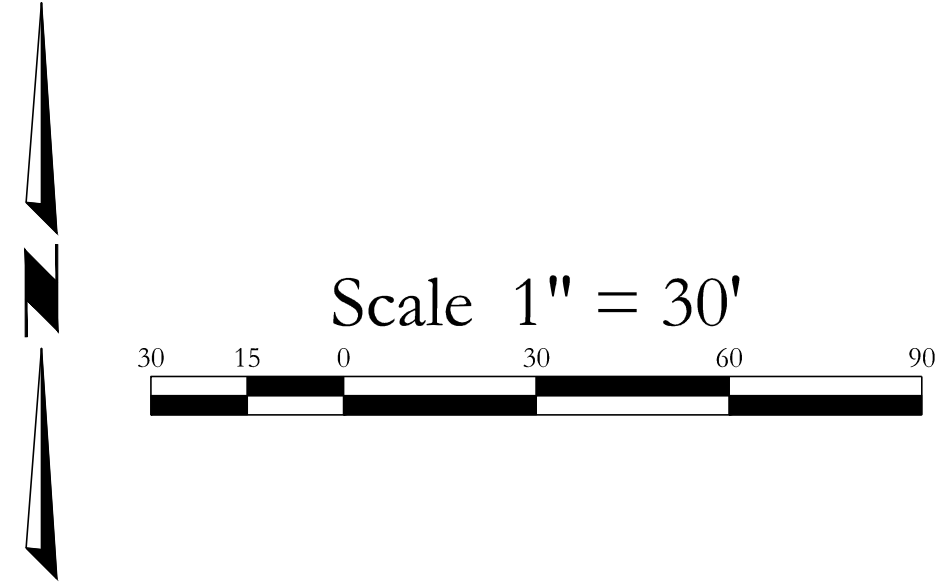

PBS Engineering and Environmental LLC
1325 SE Tech Center Dr., Ste. 140
Vancouver, WA 98683
360.695.3488
pbsuaa.com

PBS

PROFESSIONAL LAND SURVEYOR
JERRY L. GOODMAN
STATE OF WASHINGTON
REG. NO. 30446

TOPOGRAPHIC SURVEY
PE ELL K-12 SCHOOL
519 N 2ND ST
PE ELL, WA 98572

REVISIONS	
REV.	DESCRIPTION:

DATE	9/4/2024
DRAWN	MDL/TLG
SURVEYED	TRG/JSF/JCB
CHECKED	TLG

JOB NO.:
78253-00

DRAWING NAME:
78253-000-TOP0

SHEET NO.
5/6

LOCATED IN THE NORTHWEST ONE-QUARTER OF SECTION 34,
TOWNSHIP 13 NORTH, RANGE 5 WEST, WILLAMETTE MERIDIAN,
LEWIS COUNTY, WASHINGTON

Environmental LLC
1325 SE Tech Center Dr., Ste. 140
Vancouver, WA 98683
360.695.3488
pbsusa.com

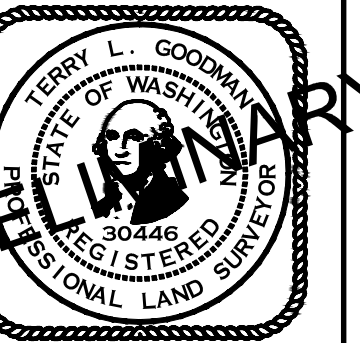

TOPOGRAPHIC SURVEY

PE ELL K-12 SCHOOL

319 N 2ND ST
PE ELL, WA 98572

[illegible]

DATE	9/4/2024
RAWN	MDL/TLG
SURVEYED	TRG/JSF/JCB
CHECKED	TLG

OB NO.:
78253-00

DRAWING NAME:
78253-000-TOPO





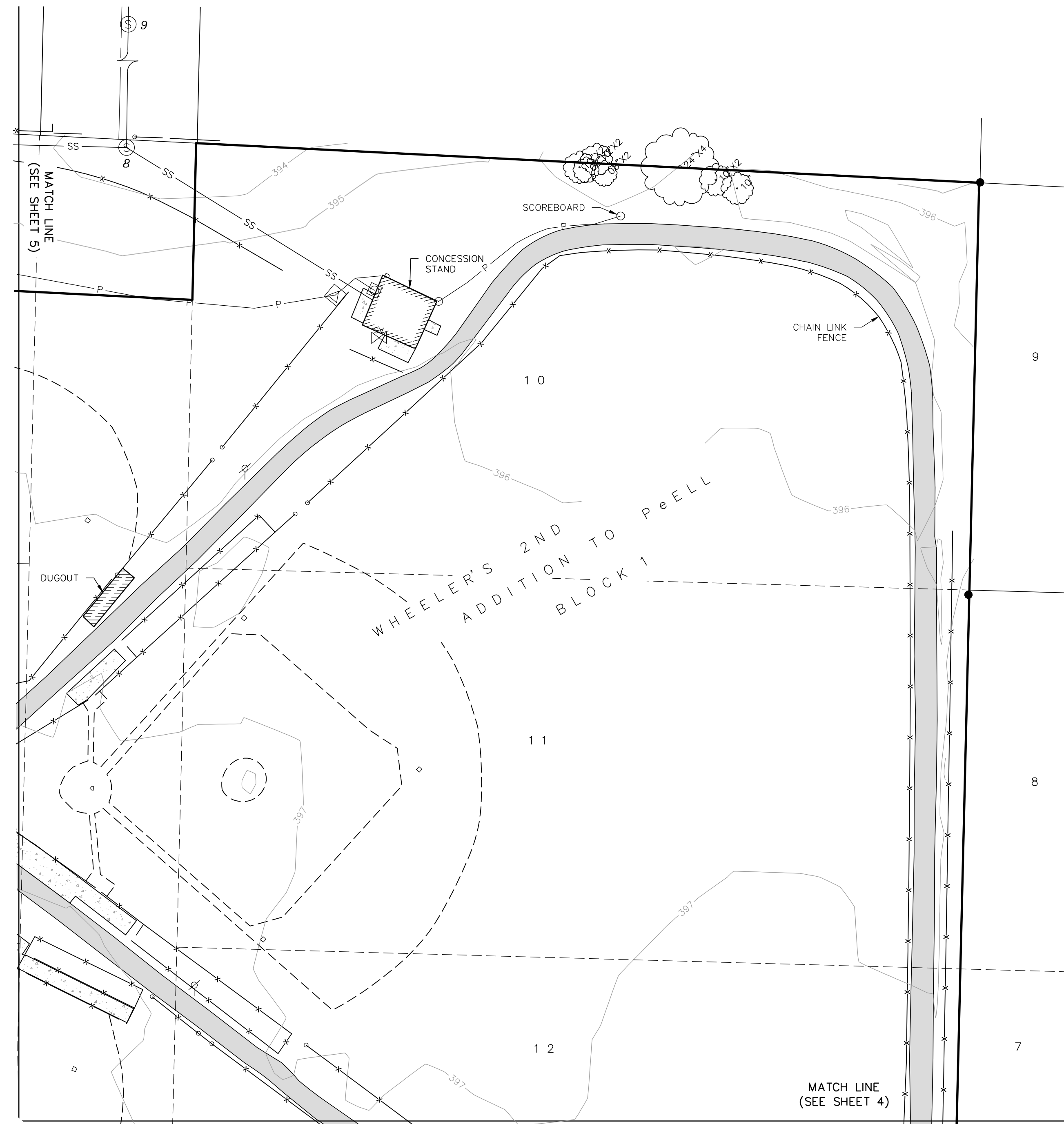









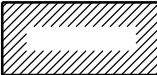



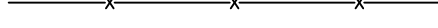

HEET NO.

5/6



8 SANITARY SEWER MANHOLE
RIM=393.20'
IE 6" +/- (SE)=391.35'*
IE 10" +/- (W)=384.12'
IE 10" +/- (N)=383.96'
*APPROXIMATE CONNECTION
TO BUILDING - COULD NOT
FIELD VERIFY

9 SANITARY SEWER MANHOLE
RIM=390.38'
IE 10" +/- (N)=382.38'
IE 10" +/- (S)=382.52'

	- DENOTES SITE BENCHMARK (SEE SHEET 2)
	- DENOTES FOUND SURVEY MONUMENT
	- DENOTES ASPHALT SURFACE
	- DENOTES CONCRETE SURFACE
	- DENOTES EXISTING BUILDING AS NOTED
	- DENOTES 5' CONTOUR INTERVAL
	- DENOTES 1' CONTOUR INTERVAL
	- DENOTES ROAD CENTERLINE
	- DENOTES RIGHT OF WAY LINE
	- DENOTES PROPERTY/LOT LINE
	- DENOTES FENCE LINE AS NOTED
	- DENOTES POWER/SIGNAL LINE PER UTILITY LOCATE PAINT/VISUAL FIELD OBSERVATION
	- DENOTES SANITARY SEWER LINE PER UTILITY LOCATE PAINT/VISUAL FIELD OBSERVATION
	- DENOTES SANITARY SEWER MANHOLE
	- DENOTES WATER SPIGOT
	- DENOTES SPRINKLER VALVE
	- DENOTES POWER/ELECTRICAL TRANSFORMER
	- DENOTES POWER METER
	- DENOTES UNKNOWN UTILITY STANDPIPE
	- DENOTES GATE POST
	- DENOTES DECIDUOUS TREE



Scale 1" = 30'

