

Furlow Charter School - 152 x 64 Modular Classroom Complex

FRAME:

- Outrigger (1) 12'x64' – 12"x11.8# I-Beam – Outriggers/Crossmembers @ 4' O.C.
***restroom module
- Outrigger (10) 14'x64' – 12"x11.8# I-Beam – Outriggers/Crossmembers @ 4' O.C.
- Axles (6) 3-Brake & 3-Idler 6000#

FLOOR:

- Joist 2x8 @ 16" O/C (Single Rim Joist)
- Decking ¾" T&G Sturd-I-Floor Plywood
- Insulation R-30 Unfaced
- Covering Floor Tile VCT 1/8"x12"x12"
- Misc. Bottom Board Mobiflex – Simplex

EXTERIOR WALL:

- Studs 2x6 @ 16" O/C W/ Dbl Top & Sgl Bottom Plate 08'03" Tall
- Sheathing 7/16" OSB
- Siding R-Panel 29 ga. Painted w/ Housewrap
- Overhang 6: Overhang Over End Walls & Side Walls
- Skirting Vinyl Skirting
- Insulation R-19 Kraft Fiberglass Batts

INTERIOR WALL:

- Studs 2x4 @ 16" O/C w/ Dbl. Top & Sgl. Bottom Plate 08'-3" Tall (Int)
- Insulation R-13 Unfaced Int. Wall @ 8' Tall
- Covering 5/8" Vinyl Covered Gyp w/ Wrapped Battens 8'-3" Tall (Int)
- Columns 2x4x8' Column Concealed
- Misc. Wall Extended to Rafters Approx. 2 ft.
***corridor walls

INTERIOR TRIM:

- Cove Base Wall Base Vinyl 4"
***throughout

ROOF:

- Mate Beam Girder Span to 30'
- Mate Beam Girder Ladder Truss H Style Roof System
- Insulation R-38 Unfaced "Non-Cath" (Roofs)
- Decking 7/16" OSB Decking
***with FR Adhesive
- Covering EPDM .045 White
- Ceiling 2x4 T-Grid – Radar #2310 (w/ Grid)
***installed after sprinkler system on site
- Truss Truss – Transverse @ 24" O/C – w/ No Bottom Cord – 12' Wide
- Truss Truss – Transverse @ 24" O/C – w/ No Bottom Cord – 14" Wide

WINDOW:

- Window – Custom (24) 36x60 Vinyl Single Hung Low E Vertical Slide
***egress windows
- Blinds (24) Vinyl Mini-Blind

EXTERIOR DOOR:

- Door (2) 72x80 Commercial Steel Double Door
- Lockset (4) Panic Tell 8300 Keyed Lever
- Hardware (2) Removable Mullion
- Hardware (4) Closer Tell 600 Series
- Hardware (4) Kick Plate 08x34” Stainless Steel
- Misc. (4) Vision Panel 04x25x1/4” Clear Temp – Frame & Glass Installed

INTERIOR DOOR:

- Door (17) 36x80 Prefinished Imperial Oak Solid Core w/ Metal Jamb
- Lockset (14) Keyed Grade 2 Lever
*** (1) storage function (10) classroom function (3) keyed office locks
- Lockset (1) Privacy Grade 2 Lever
***staff restroom
- Lockset (2) Push-Pull
***multi-user restrooms
- Hardware (17) Door Stop Floor Mount (Int. Doors)
- Hardware (14) Kick Plate 08”x24” Stainless Steel (Int. Doors)
***corridor doors
- Hardware (2) Closer Tell 600 Series (Int. Doors)
***multi-user restrooms

ELECTRICAL:

- Panel (11) 1 Phase Nema 1 Internal 125 Amp
- Raceway Romex Wire Assembly (12-2)
- Raceway MC Cable 12/2 w/ Ground
***above ceiling
- Light (122) Flat Panel LED 2x4 Standard
- Exterior Lights (2) Exterior 20W LED w/ Photocell
***hardwired no switch
- Exit/Emergency (2) Exit Emergency Light Remote Capable – Red
- Exit/Emergency (2) Emergency Light Remote Head Exterior
- Exit Emergency (6) Emergency Light Dual Head
- Switch (2) Occupancy Sensor Ceiling Mount
***in multi-user restrooms
- Switch (15) Occupancy Sensor Wall Mount
- Switch (2) 20 Amp 3-Way
- Receptacle (2) 20 Amp GFCI Protected Duplex Tamper Resistant
***in staff restroom & janitor’s closet
- Receptacle (1) 20 Amp WR for Heat Tape

ELECTRICAL CONTINUED:

- Receptacle (170) 20 Amp Duplex Tamper Resistant
- Receptacle (11) 20 Amp WR GFCI Protected w/ While in Use Cover
- Phone/Data (14) 4x4 J-Box w/ Mud Ring & 1" Conduit Stub Out
***for site installed horn/strobe
- Phone/Data (2) 2x4 J-Box w/ 3/4" Conduit Stub Out
***for site installed pull station
- Fire Alarm As required by State of Georgia Fire Marshall
- Misc. (19) Cross Over

PLUMBING:

- Pipe Pipe Pex 3/4"
- Water Closet (3) Water Closet Tank Type Handicap PEX
- Water Closet (6) Water Closet Tank Type Elongated PEX
- Urinals (2) Urinal PEX
- Lavatories (11) Lavatory Wall Hung PEX
- Drinking Fountain (1) Water Cooler Hi/Low w/ GFI
- Mop Sink (1) Mop Sink Fiberglass w/ Legs PEX
- Floor Drain (2) Floor Drain w/ Trap Guard
***in multi-user restrooms
- Water Heater (1) 20 Gallon Elec. Water Heater 2500-Watt Single Element PEX Supply
- Accessories (3) Towel Dispenser
- Accessories (9) Jumbo Toilet Paper Dispenser Bobrick B-2890
- Accessories (7) Soap Dispenser
- Accessories (1) Partition Urinal Screen
- Accessories (6) Partition Standard Stall (Non-ADA)
- Accessories (2) Partition Handicap Stall
- Accessories (11) Mirror 18"x36" Stainless Steel Trim
- Accessories (3) Grab Bars Set
- Accessories (3) Grab Bar 18" Vertical
- Misc. (4) Water Hammer Arrestor 3/4"
- Misc. (1) Thermostatic Mixing Valve 170
- Fire Sprinkler Required by Code Installed on Site

HVAC:

- A/C Wall Mount (11) 3.0 Ton Dehum 10kw Heat Strip w/ Programmable T-Stat
***Bard or Eubank or Equal
- Duct Fiberglass / Flex Return Air Duct
- Duct Fiberglass / Flex Supply Air Duct
- Exhaust Fans (2) 350 CFM Ceiling Mount
***in multi-user restrooms
- Exhaust Fans (2) 90 CFM Ceiling Mount
***in staff restroom & janitor's closet
- Misc. Plenum Wall Wood

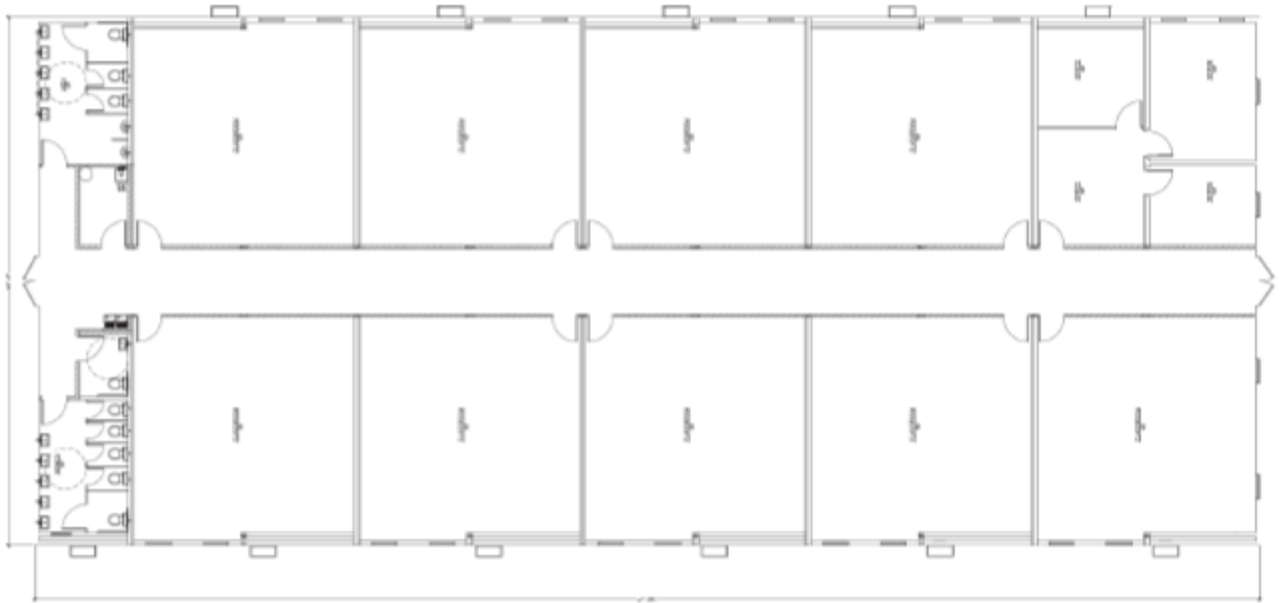

- (9) Classrooms
- (3) Private Offices
- (2) Handicap Accessible Restrooms
- Exterior Door on Each End of Building
- Aluminum Decks, Steps, and Ramps