

# 8th Grade Night



Houston County  
High School

Spring 2024

# Welcome to Bear Country!



**Dr. Jay Jones**  
**Principal**  
**Houston County High School**

# Assistant Principals



Jared Allen  
Assistant  
Principal of  
Discipline

Last Names  
A-D



Jason Brett  
Assistant  
Principal of  
Discipline,  
Athletic Director

Last Names  
E-K



Trindy Rawlins  
Assistant  
Principal of  
Instruction



Karma Hayes  
Assistant  
Principal of  
Discipline,  
CTAE Supervisor

Last Names  
L-R



Melanie Moore  
Assistant  
Principal of  
Discipline



# HCHS Counselors



Mrs. Jenny Dykes  
Last Names: A-D



Mrs. Melanie Hudson  
Last Names: E-K



Dr. Lori Sarazine  
Last Names: L-R



Dr. Melissa Jones  
Last Names: S-Z



Ms. Donna Green  
Special Programs/  
Testing



# 23-24 HCHS Department Chairs



Dr. Jennifer Bowers  
World Language



Ms. Shayna Brown  
CTAE



Mrs. Randi Collier  
Gifted Education



Mrs. Lyndsey Cumpton  
Science



Mrs. Amanda Heavner  
Interrelated



Dr. Donna Milling  
English



Mrs. Lauren Nguyen  
Social Studies



Mrs. Tiffany Rumell  
Self-Contained



Ms. Brandee Tillman  
Math



Dr. Katherine Wyatt  
Fine Arts

# Parent Pickup/Dropoff

- Students should be dropped off and picked up ONLY in the front or back of the building.
- Front drop off/pickup is located at the front of the school off of Highway 96.
- Back drop off/pickup is located in the back parking lot off of Jerry Barker Dr.



Bear Country Boulevard

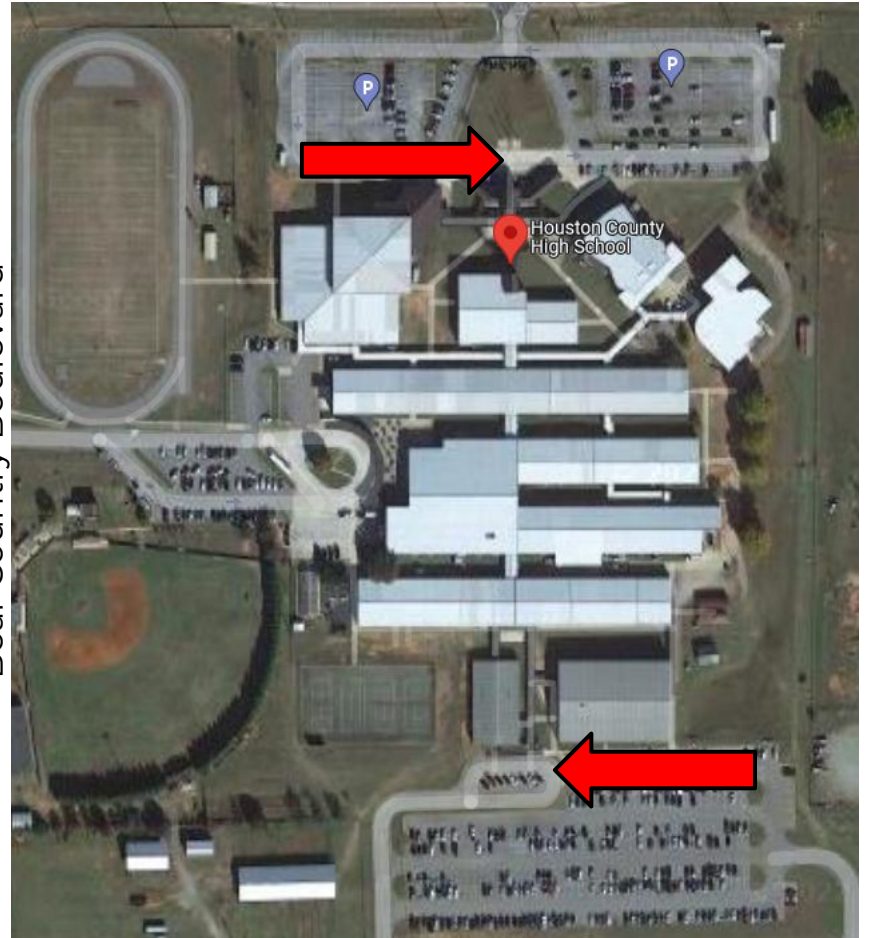

Highway 96

Sutherland Drive

Jerry Barker Drive

# Parent Pickup/Dropoff

The side lot & bus ramp are NOT to be used for parent pick up or drop off.



Bear Country Boulevard

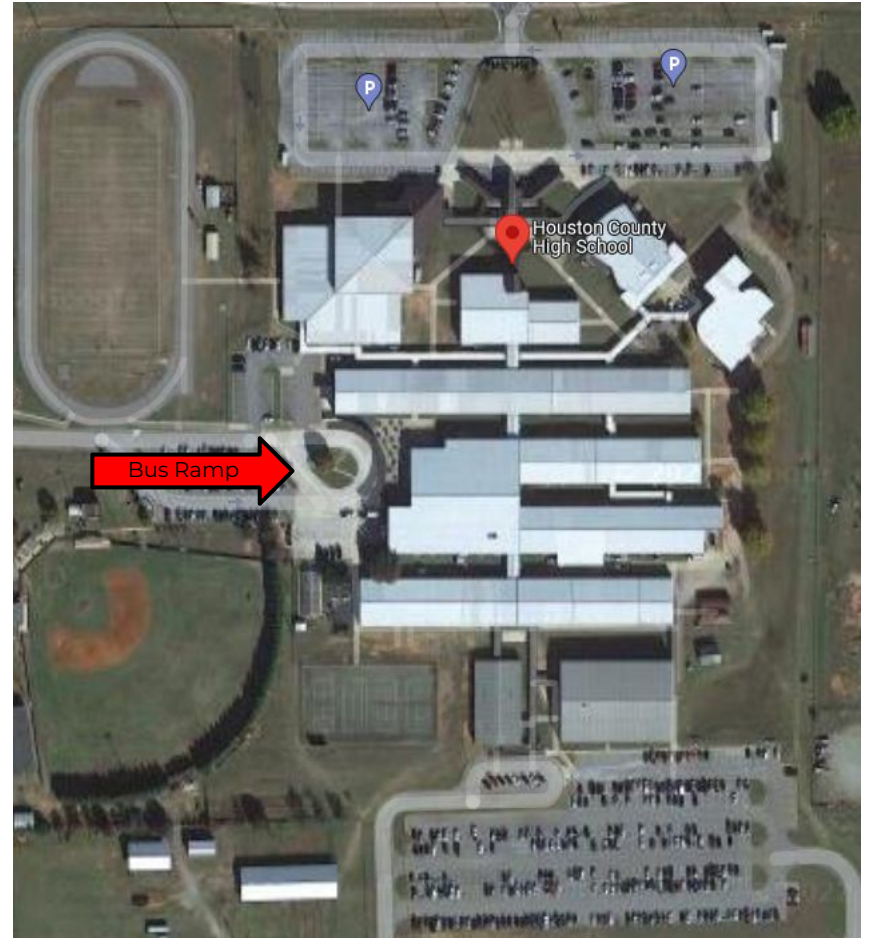

Sutherland Drive

Highway 96

Jerry Barker Drive

# Dress Code

- No Hats/Hoods on your head at any time
- No Undergarment exposure
- Skirts, Dresses, and Shorts must reach mid-thigh
- No holes above mid-thigh that allow skin to show
- No crop tops that allow skin to show
- Bandanas (or bandana print) of any color are prohibited.
- Leggings may be worn, but a dress, shirt, or skirt must be worn over the leggings. The dress, shirt, or skirt must be mid-thigh length or longer.
- Pajama pants are not permitted.

# Electronic Devices

- Cell phones and earbuds/headphones are not allowed during the school day, except for during lunch.
- Lunch phone rules:
  - No photos or videos should be taken
  - No music should be played from the phone
  - No calls are to be made or received
- If wearing earbuds/headphones while going to a parking lot or before/after school, only one ear should be in use/covered for safety purposes.

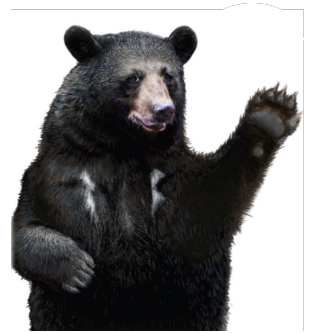

# Athletics/Extracurricular Activities

- All 9th grade students are eligible to participate in athletics during Fall semester. To be eligible to participate in the spring, students must pass 5 out of 7 classes.
- Physicals are required to participate in athletics and should be uploaded in Dragonfly.

<b>Examples of Clubs/Extracurricular Activities</b>	<b>2023-2024 Athletics</b>
Air Force JROTC Black and Silver Brigade Band Beta Club Creative Writing Club Debate Team DECA FCCLA FCA French Club FBLA FFA National Honor Society Partner's Club Pep Club Robotics Alliance Sources of Strength Student Council Technology Student Association	Baseball Basketball- Girls and Boys Bass Fishing Basketball Cheerleading Football/Competition Cheerleading Cross Country-Girls and Boys E-Sports Girls Flag Football Football Golf- Girls and Boys Soccer- Girls and Boys Swimming-Girls and Boys Softball Tennis-Girls and Boys Track-Girls and Boys Volleyball Wrestling- Girls and Boys



# Lunch Information

- Students will attend lunch with their 5th period class.
- Students can eat the Main Cafeteria, Middle Cafeteria, or Outdoor Dining area, but not the Senior Cafeteria.
- Multiple line options are available in all cafeteria areas.

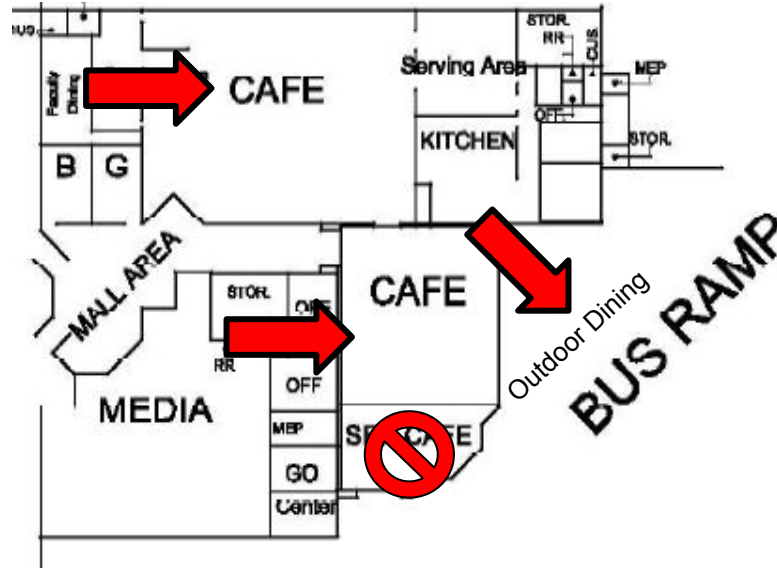

# Class Transitions

- Students have freedom to travel through the entire building during transition, and will not be escorted class-to-class. It is the student's responsibility to follow the shortest and quickest route to avoid being tardy.
- There are 5 minutes between classes. There is a bell to warn students that they have 1 minute to be in class as well as a tardy bell to begin each period.
- Late entry to each class period will produce tardies, which carry consequences. Students will have the first few days of school before they are counted tardy for classes.



# Grading/GPA Information

- Your Georgia high school HOPE GPA starts calculating as soon as you begin 9th grade. Your overall high school GPA, includes all courses attempted during the high school years.
- Each students' HOPE GPA only includes core curriculum courses:
  - English
  - Math
  - Science
  - Social Studies
  - Foreign Language

HOPE Scholarship Academic Eligibility Requirements as an entering freshman at an eligible college or university in Georgia (after high school graduation)

- Students Must Meet the following criteria:
  - Graduate with a minimum 3.0 calculated HOPE GPA.
  - Earn a minimum of four full rigor credits from the [Academic Rigor Course List](#).

# Course Selection: Electives

## CTAE

- Basic Agricultural Science
- Food Nutrition and Wellness
- Early Childhood Education
- Entrepreneurship Essentials
- Foundations of Engineering- *\*Must have an 85 or higher in Math.*
- Introduction to Graphics
- Fine Furniture 1
- Jr ROTC Aerospace Science
- Introduction to Software Technology
- Introduction to Business and Technology
- Marketing Principles

## PE

- Lifetime Sports
- Team Sports

## Fine Arts

- Band
- Theater Fundamentals (Drama)
- Beginning Men's Chorus
- Beginning Women's Chorus

## World Language

- French 1- *\*Must have a 95 or higher in Honors Language Arts*
- Spanish 1- *\*Must have a 95 or higher in Honors Language Arts*

# Course Selection: CTAE (Electives)

- Be intentional
  - Have the conversations to talk through the best fit
  - Use presentation posted to guide you
    - Pay attention to labs, skills, interests, career options
- Highly encourage participation in CTSOs (Career Technical Student Organizations)
  - Leadership, competition, scholarships
- 3 years of a pathway + passing End of Pathway Assessment = Cord for Graduation

# Plant Science (Agriculture)

## Description:

Introduces the major areas of scientific agricultural production and research focused on plant & horticulture science. Builds introductory skills & knowledge in agricultural science and agri-related technologies.

## Skills/Interests:

- Agriculture
- Plant Science/Botany
- Hands-on learning
- Leadership
- Discipline
- Working with plants

## End of Pathway Assessment:

Horticulture NOCTI

CTSO: FFA

## Careers:

- Environmental Scientist
- Hydrologist
- Landscape Architect
- Botanist
- Turf Management Specialist
- Biologist

## Pathway Courses:

1. Basic Agricultural Science
2. General Horticulture & Plant Science
3. Nursery & Landscape



## Lab Details:

Greenhouse work daily

If this pathway  
interests you, sign  
up for...

**BASIC AG**

# Food Animal Systems (Agriculture)

## Description:

Introduces the major areas of scientific agricultural production & research focused on the raising of agricultural livestock.

## Skills/Interests:

- Agriculture
- Farm Management
- Leadership
- Discipline
- Working with animals
- Teamwork

## End of Pathway Assessment:

Precision

CTSO: FFA

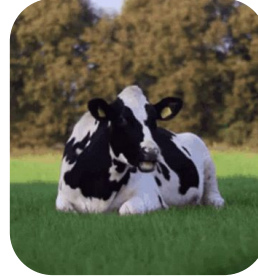

## Careers:

- Veterinarian
- Farm & Ranch Managers
- Animal Scientist
- Animal Trainers
- Biologists
- Zoologists

## Pathway Courses:

1. Basic Agricultural Science
2. Animal Science & Biotechnology
3. Agricultural Animal Production & Management

## Lab Details:

- Farm/Barn-daily (rain or shine)
- Work boots required

If this pathway  
interests you, sign  
up for...  
**BASIC AG**

# Nutrition and Food Science

## Description:

- Project-Based Learning Course focused on wellness and nutrition necessary for being well and living healthy

## Skills/Interests:

- Teamwork
- Public Speaking
- Strong Science Background
- Organizational Skills
- Projects

## End of Pathway Assessment:

ServSafe Food Handler

## CTSO: FCCLA

## Careers:

- Dietician
- Nutritionist
- Food Scientist
- Dietetic Tech
- Fitness & Wellness Coordinator
- Food Service Managers

## Pathway Courses:

- Food, Nutrition, and Wellness
- Food for Life
- Food Science

**Lab Details:** Labs are reserved for upper level courses. Hair must be tied back, closed toed shoes must be worn, and no jewelry in the lab



If this pathway  
interests you, sign  
up for...  
**Food, Nutrition,  
& Wellness**

# Early Childhood Education

## Description:

- Project-Based Learning Course focusing on child development and practices for working with young children

## Skills/Interests:

- Teamwork
- Strong Work Ethic
- Communication Skills
- Organizational Skills
- Working with Children
- Project-Based Learning

## End of Pathway Assessment:

NOTI Early Childhood Education & Care

CTSO: FCCLA

## Careers:

- Teacher
- Preschool / Daycare Worker
- Counselor
- Child Life Specialist
- Social Worker

## Pathway Courses:

- Early Childhood Education I
- Early Childhood Education II
- Early Childhood Education III

## Lab Details:

Students in ECE II and ECE III have the opportunity to work with young children in Little Bears Preschool.



If this pathway  
interests you, sign  
up for...  
**Early Childhood  
Education**

# Start-Up Entrepreneurship

## Description:

- Entrepreneurial Self Discovery
- Planning Your Future Business
- *Running your own business*

CTSO: Future Business Leaders of America

## Careers:

- CEO of Your Own Company
- Business Managers

## Pathway Courses:

1. Entrepreneurship Essentials
2. The Entrepreneurial Venture
3. Advanced Entrepreneurial Strategies

## End of Pathway:

National Industry Credential Assessment

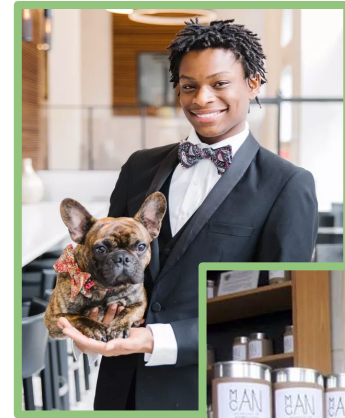

If this pathway  
interests you, sign up  
for...  
**Entrepreneurship  
Essentials**



# Engineering

## Description:

- Introduces basic engineering disciplines
- Project-based curriculum

## Skills/Interests:

- Analytical
- Strong Math Sense
- Good with Hands-On Projects

## End of Pathway Assessment:

- NOCTI Engineering Assessment

## Careers:

- Engineering

## CTSO:

- Technology Student Association (TSA)

## Lab Details:

- Hands-On Projects
- Lab Fee

## Pathway Courses:

1. Foundations of Engineering
2. Engineering Concepts
3. Engineering Applications

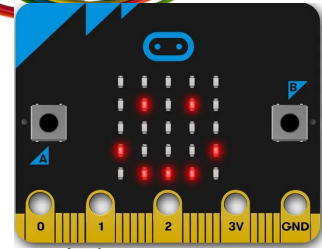
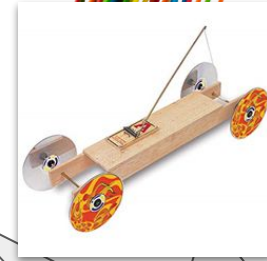
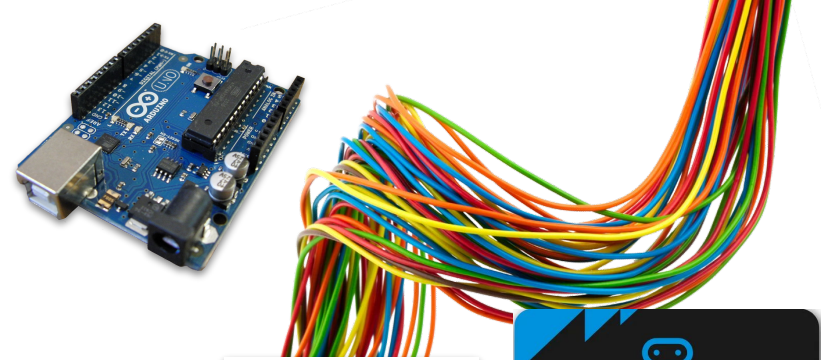

If this pathway  
interests you, sign  
up for...

**Foundations of  
Engineering**

# Graphics



## Description:

- Learning Graphic Design
- Exploring the Elements of Art and Principles of Design
- Print Graphics and Digital Art

## Pathway Courses:

Introduction to Graphic Design  
Graphic and Production  
Advanced Graphics

## Careers:

Graphic Designer  
Digital Artist  
Photographer/ Videographer  
Entrepreneur  
Illustrator  
Print Shop

## Skills/Interests:

Computer Proficient  
Digital Art  
Specialty Printing  
Layout Design

## End of Pathway Assessment:

SkillsUSA Skills  
Connect Ad Design

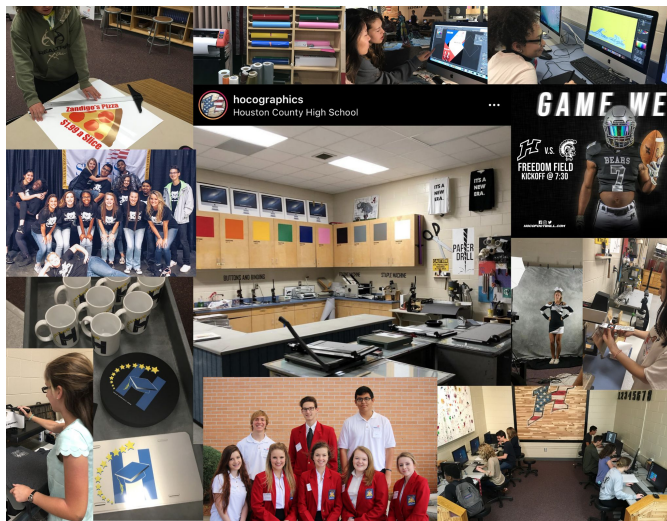

## Lab Details:

Full Service Print Shop  
including wide format  
printing, sublimation, digital  
press and more!

If this pathway  
interests you, sign up  
for...

**Introduction to  
Graphic Design**

# Fine Furniture and Cabinetmaking

## Description:

- ❑ Students will build handmade furniture from solid wood at a professional level
- ❑ Hands on: learning heavy machinery
- ❑ Building and creating furniture
- ❑ HCHS Furniture Site

## Skills/Interests:

Strong Work Ethic  
Eye for Design  
Learns By Doing  
Woodworking



End of Pathway Assessment:  
NOCI Cabinetmaking

## Pathway Courses:

Fine Furniture and Cabinetmaking 1  
Fine Furniture and Cabinetmaking 2  
Fine Furniture and Cabinetmaking 3



HOUSTON COUNTY  
**SkillsUSA**  
HIGH SCHOOL

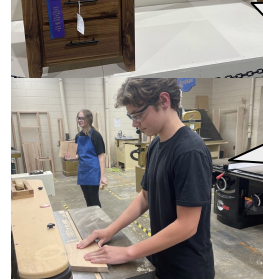

CTSO: SkillsUSA

## Lab Details:

- ❑ Lab fee required
- ❑ Additional material cost are needed
- ❑ 90% or better on all machine test
- ❑ Full woodshop with dress code requirements
- ❑ No jewelry, no loose clothing, closed toe shoes

If this pathway  
interests you, sign  
up for...  
**Fine Furniture 1**

# AFJROTC: Air Force Junior Reserve Officer Training Corps

## Description:

Students will take a variety of courses that cover basic military customs and courtesies, Air Force history, physical/ health education, management, cultural awareness, and space exploration.

## Skills/Interests:

Leadership, management, team building, citizenship, attention to detail, camaraderie, drive & determination

## Pathway Courses:

AS/LE 100, AS/LE200, AS/LE300 & AS/LE400

## Careers:

Active/reserve military (5 Branches of Service), computer science, engineering, technology, math professions

Lab Details: N/A

End of Pathway Assessment: N/A

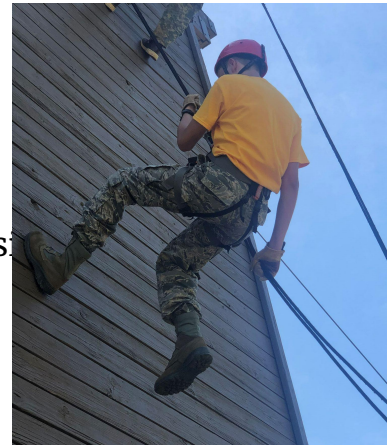
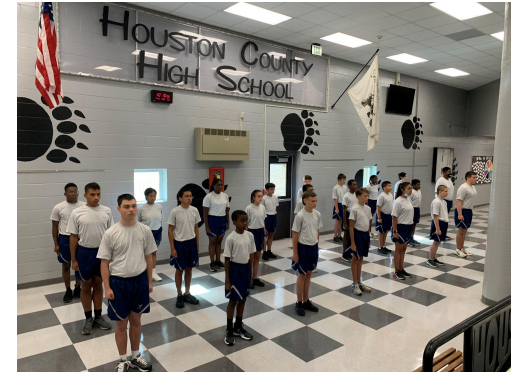

Summer Leadership Camp  
Georgia Military College: Repel Tower





# Computer Science

## Description:

Students cultivate their understanding of coding through analyzing, writing, and testing code as they explore concepts like modularity, variables, and control structures.

## Skills/Interests:

- Problem-solving
- Collaboration
- Curiosity
- Creativity

## End of Pathway:

NOCTI Computer Programming

CTSO: FBLA

## Careers:

- Software Engineer
- Mobile App Developer
- IT Project Manager

## Pathway Courses:

- Introduction to Software Technology
- Computer Science Principles or AP Computer Science Principles
- AP Computer Science A



If this pathway  
interests you, sign  
up for...  
**Introduction to  
Software  
Technology**

# Human Resources Management

## Description:

**HIRED OR FIRED?** Learn the hiring, managing, and firing functions of a job. Students also get an overview of business and technology skills required for today's business environment.

## Skills/Interests:

Microsoft Office  
Google Apps

## End of Pathway Assessment:

NOCTI Human Resources  
Management Exam

## CTSO:

FBLA

## Careers:

- ★ CEO (Chief Executive Officer)
- ★ Business Manager or Agent
- ★ Human Resources Manager
- ★ Business Analyst
- ★ Administrative Assistant

## Pathway Courses:

1. Intro to Business & Technology
2. Legal Environment of Business
3. Human Resources Principles



If this pathway  
interests you, sign  
up for...

**Introduction to  
Business &  
Technology**

# Business Accounting

## Description:

- Where does all the money go? Students will learn how to make decisions about planning, organizing, and allocating resources using accounting procedures. Students will also learn to understand the importance of the financial world, including planning and managing money wisely.



CTSO: Future Business Leaders of America

## Skills/Interests:

- Professional communication skills & practices
- Problem solving
- Presentation skills

## Careers:

- Web Developer
- UX Design
- Web Designer
- Cybersecurity

## End of Pathway Assessment:

Business Financial Management

## Pathway Courses:

- Introduction to Business Technology
- Financial Literacy
- Accounting I

If this pathway  
interests you, sign up  
for...  
**Intro to Software  
Technology**

# Sports & Entertainment Marketing

## Lab Details:

- 3rd & 4th year Marketing students work Bear Necessities (SBE/School Store)
- 2nd level and up participate in Fantasy Sports projects

## Description:

- Explore the value of marketing in everyday life
- Use marketing strategies and concepts to prepare yourself for ANY career
- Job experience in School Based Enterprise (SBE/school store)

## Skills/Interests:

- Sports and Entertainment
- Teamwork
- Initiative
- Strong Work Ethic
- Creativity
- Customer Service Mindset
- Project Based Learning



## End of Pathway Assessment:

MBA Research Standard Marketing Program of Study Exam (NOCTI)

CTSO:  **DECA**

## Careers:

- Sports Agent
- Social Media Manager
- Entrepreneur
- Public Relations
- Event Management
- Travel & Tourism Agent (Sales)

## Pathway Courses:

1. Marketing Principles
2. Intro to Sports & Entertainment Marketing
3. Advanced Sports & Entertainment Marketing





# Fine Arts



## Band

Provides opportunities to develop performance skills on a wind, brass, or percussion instrument. Emphasizes performance and production. Organizes objectives for self-paced progress. Stresses individual progress and group experiences.



## Beginning Men's and Women's Chorus

Provides opportunities for young men and young women to develop performance skills and knowledge in all-male or all-female choral singing.

# Theater Fundamentals

This course serves as an introduction to the theatre arts. Students investigate theatre as a whole by exploring the techniques and origins of a wide variety of theatre arts in various cultures and periods.



# World Language



## French 1

Introduces the French language; emphasizes all skills: listening, speaking, reading, and writing in an integrated way. Includes how to greet and take leave of someone, to ask and respond to basic questions, to speak and read within a range of carefully selected topics and to develop an understanding of French-speaking cultures.

## Spanish 1

Introduces the Spanish language; emphasizes all skills: listening, speaking, reading, and writing skills in an integrated way. Includes how to greet and take leave of someone, to ask and respond to basic questions, to speak and read within a range of carefully selected topics and to develop an understanding of Spanish-speaking cultures.

**\*\* If students are interested in completing an AP Foreign Language course they must take Spanish 1 or French 1 as a 9th grader or test in to Spanish 2 or French 2\*\***

# Registration Overview

Students will take 7 classes *per semester* worth 0.5 credit each. Obtaining 5 credits is required to earn classification as a sophomore, which means 10/14 classes must be passed. Your high school GPA begins at the end of Fall semester, so a good start is important.

Registration is for the full academic year 2023-2024. Students take part A of each course first semester and part B second semester.

As a freshman, 5 classes are required

- 9th Grade Literature
- Algebra 1 or Honors Geometry
- Biology
- American Government/World Geography
- Health & Personal Fitness
  - ◆ In Health, students will fulfill the requirements for ADAP, which is required to receive a Georgia driver's license.

The remaining 2 classes are electives.

Students will select four elective classes in order of their preference on their registration form.

We do our very best to schedule the top two selections, however if those classes are full or do not fit in the schedule, the third and fourth choice may be scheduled.

*\*Students are not eligible for Dual Enrollment until the summer after 10th grade\**



# Registration Form

## REQUIRED COURSES

23.0610010	9th Literature/Comp A
23.0610020	9th Literature/Comp B
27.0811010	Algebra CC 1A or Geometry A H*
27.0811020	Algebra CC 1B or Geometry B H*
45.0570000	American Government/Civics
45.0711000	World Geography
26.0120010	Biology 1A
26.0120020	Biology 1B
17.0110000	Health
36.0510000	Personal Fitness

### **\*\*For Teacher Use Only\*\***

Circle one environment for each course:

Social Studies:	R	SG	CT	H
English:	R	SG	CT	H
Math:	R	SG	CT	H
Science:	R	SG	CT	H

# Registration Form

## ELECTIVE CHOICES

Directions: Select your top four elective choices. On the blank provided, write a 1 for your first choice, 2 for your second choice, 3 for your third choice, and 4 for your fourth choice. **You may only make a total of four selections.**

_____ 20.4161010	Food Nutrition and Wellness	_____ 21.4250010	Foundations of Engineering <i>*Must have an 85 or higher in Math.</i>
_____ 46.4540010	Fine Furniture 1	_____ 02.4710010	Basic Agricultural Science
_____ 28.4110010	JROTC Aerospace Science	_____ 07.4413010	Intro to Business & Technology
_____ 11.4150010	Intro to Software Technology	_____ 48.4610010	Intro to Graphics
_____ 20.4281010	Early Childhood Education	_____ 08.4740010	Marketing Principles
_____ 36.0320010	Lifetime Sports (PE)	_____ 36.0410010	Team Sports (PE)
_____ 53.0642010	Band	_____ 52.0210010	Theater Fundamentals (Drama)
_____ 60.0110010	French 1- <i>*95 or higher in Honors Language Arts</i>	_____ 54.0291010	Beginning Men's Chorus
_____ 60.0710010	Spanish 1- <i>*95 or higher in Honors Language Arts</i>	_____ 54.0241010	Beginning Women's Chorus
		_____ 06.4510000	Entrepreneurship Essentials

*Elective choices are not guaranteed as schedules are based on class availability and potential scheduling conflicts.*

Student Signature \_\_\_\_\_

Date \_\_\_\_\_

Parent Signature \_\_\_\_\_

Date \_\_\_\_\_



**Thank you!**

**Bear Down!!**

